

The Anti-social Behaviour, Crime and Policing Act 2014 Section 59

South Kesteven District Council (Alcohol Control Areas) Public Spaces Protection Order 2023

South Kesteven District Council (in this Order called “the Council”) in exercise of its powers under Section 59 of the Anti-social Behaviour, Crime and Policing Act 2014 (“the Act”) hereby makes the following Order:

The Order is made on the _____ and shall have effect for a period of 3 years thereafter, unless extended by further orders under the Council’s statutory powers.

General provisions:

1. This Order applies to all land in the Restricted Areas to which the public or any section of the public has access, on payment or otherwise, as of right or by virtue of express or implied permission.
2. The Council is satisfied that both of the conditions set out in Section 59 of the Act are satisfied, because the activity, identified in paragraph 5 of this Order, which is carried on in a public place (“the Restricted Area”) has a detrimental effect on the quality of life of those in the locality and this effect is or is likely to be of a persistent or continuing nature, such as to make the activities unreasonable and justifies the restrictions imposed by this Order.
3. The Order is available for inspection on the Council’s website and also by appointment, at the offices of South Kesteven District Council. Appointments can be made by contacting 01476 406080 or emailing neighbourhoods@southkesteven.gov.uk
4. If any interested person desires to question the validity of this Order on the grounds that the Council had no power to make it or that any requirement of the Act has not been complied with in relation to this Order, he or she may apply to the High Court within six weeks from the date on which this Order is made.

Prohibitions:

5. Alcohol control areas

The activities which are to be controlled are:

- a) A person consuming alcohol in breach of an authorised officer’s request to cease the consumption in public spaces within the Restricted Areas specified in the Schedule to this Order, where the consumption is associated with disorder, nuisance or annoyance to members of the public.
- b) A person having an unsealed container of alcohol in breach of an authorised officer’s request to surrender the alcohol or container for disposal in public spaces within the Restricted Areas specified in the Schedule of this Order, where the consumption is associated with disorder, nuisance or annoyance to members of the public.

For the purpose of this Order:

- (a) Restricted Area means the land designated in the Schedule to this Order.

- (b) An "authorised officer" means an officer who is authorised in writing by the Council for the purposes of giving directions under the Order or a police constable or a community support officer designated under the Police Reform Act 2002.
- (c) Alcohol has the meaning given in section 191 of the Licensing Act 2003.
- (d) Surrender the alcohol or container for disposal – an authorised officer may dispose of anything surrendered which they reasonably believe to be alcohol in whatever way he/she thinks appropriate.

Penalty

A person who fails to comply with any obligation imposed by this Order is guilty of an offence and liable to a fine on summary conviction not exceeding level 3 on the standard scale.

An authorised officer may issue a fixed penalty notice (currently £100) to a person who they reasonably believe has breached the requirements of this Order. A fixed penalty notice offers the recipient the opportunity to discharge the liability to conviction for the offence by paying the fixed penalty notice within 14 days of issue of the notice.

Date Order Made:

Executed as a DEED by affixing the)
COMMON SEAL of SOUTH KESTEVEN)
DISTRICT COUNCIL)

In the presence of:

Schedule

This Order applies to land which is within the administrative area of South Kesteven District Council, edged black in the attached plans, which is open to the air (which includes land which is covered, but open to the open air on at least one side) and to which the public are entitled or permitted to have access (with or without payment).

Public Space Protection Order - Alcohol Control Area

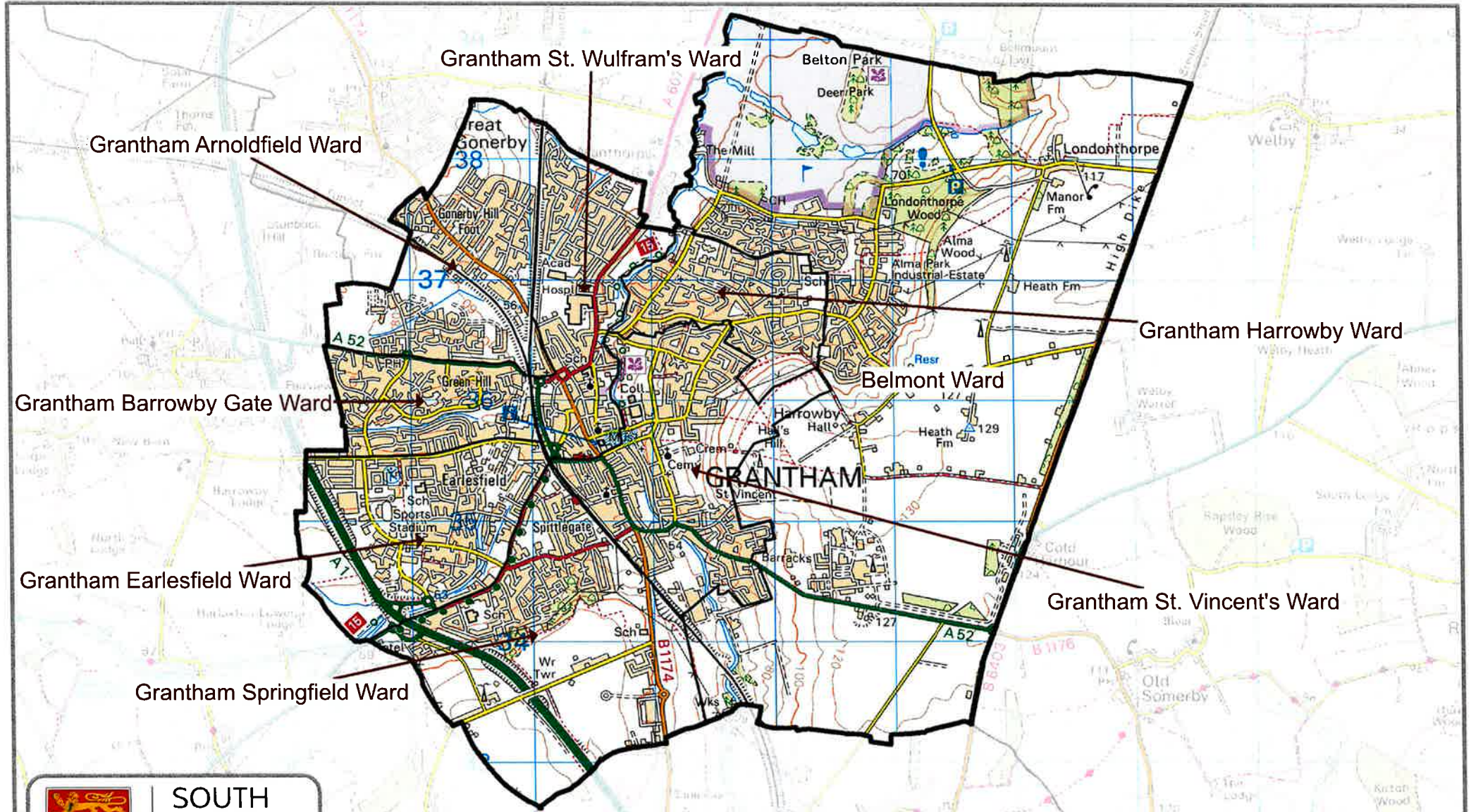

Public Space Protection Order - Alcohol Control Area

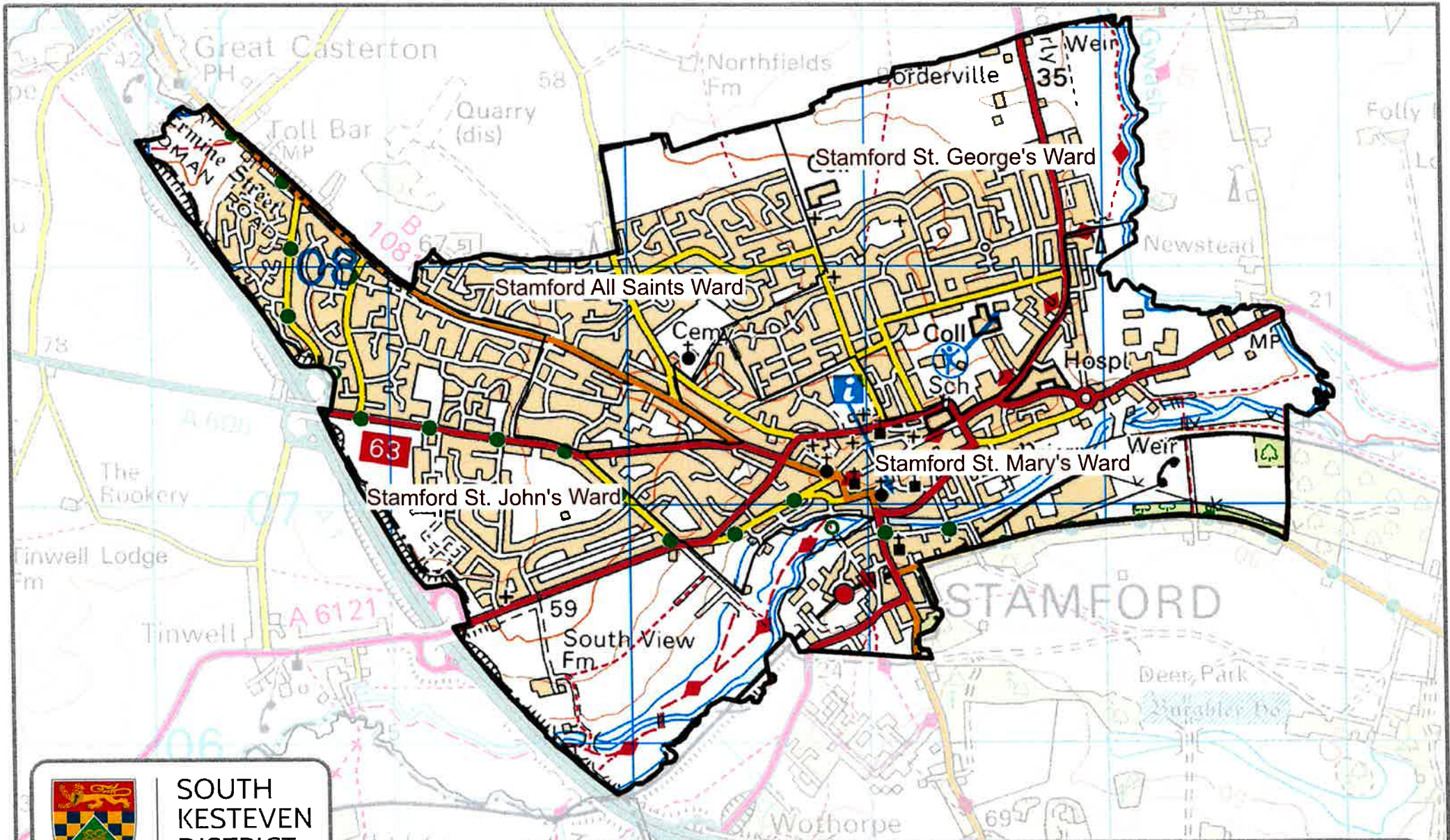

SOUTH
KESTEVEN
DISTRICT
COUNCIL

© Crown copyright and database rights 2020 Ordnance Survey 100018662

Public Space Protection Order - Alcohol Control Area

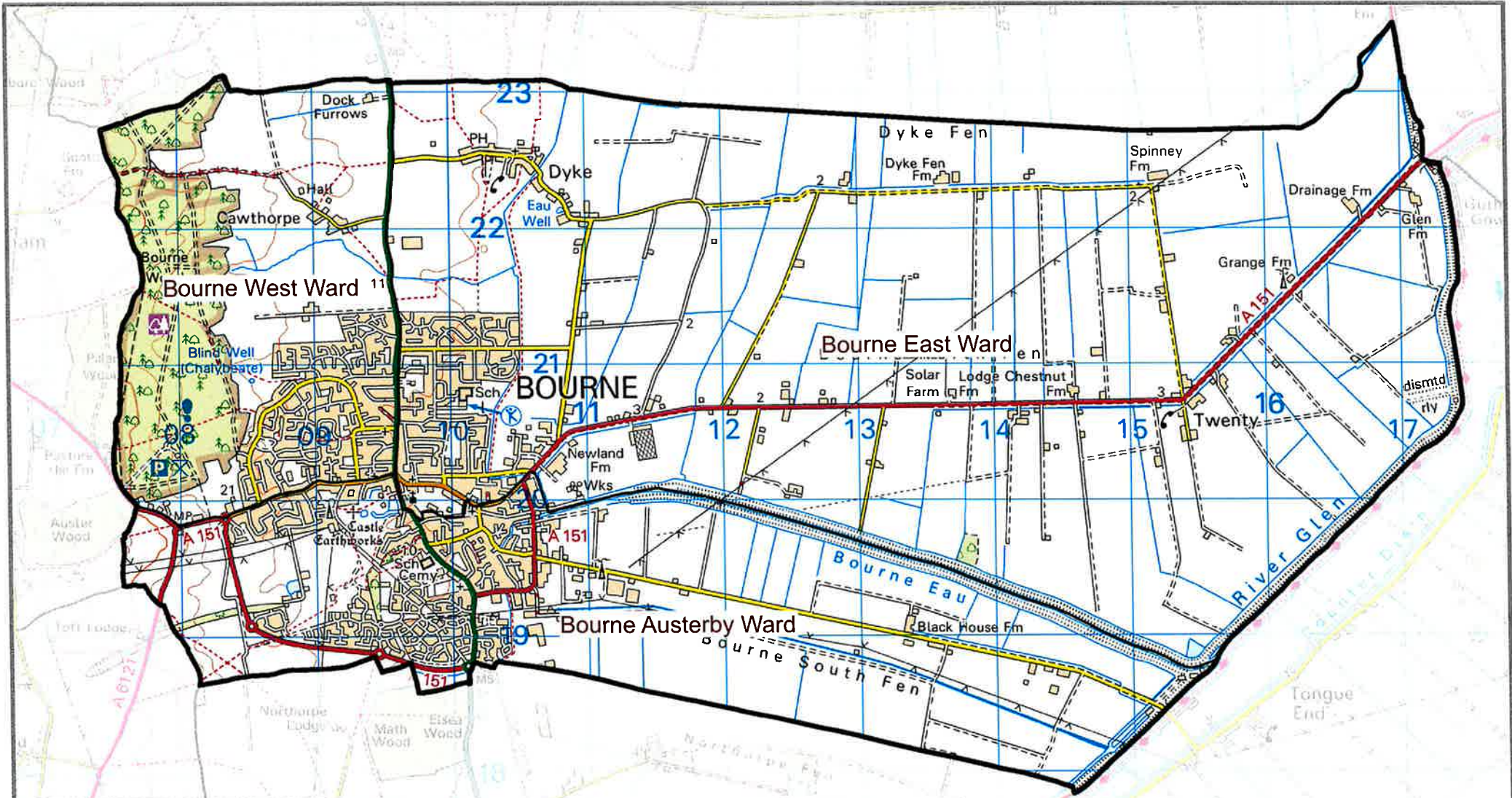

© Crown copyright and database rights 2020 Ordnance Survey 100018662

Public Space Protection Order - Alcohol Control Area

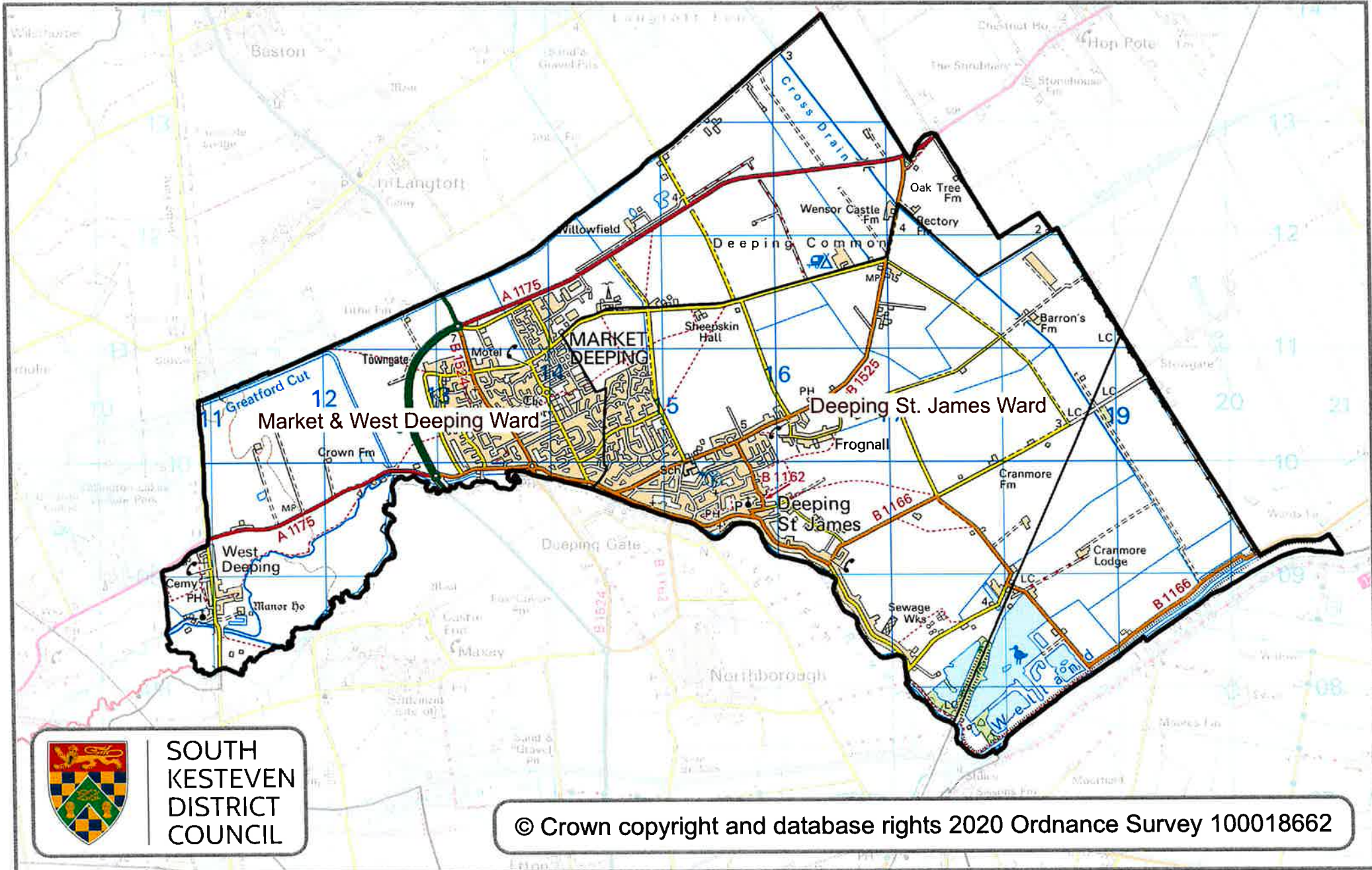

SOUTH
KESTEVEN
DISTRICT
COUNCIL

© Crown copyright and database rights 2020 Ordnance Survey 100018662

The Anti-social Behaviour, Crime and Policing Act 2014 Section 59

South Kesteven District Council (Dog Exclusion) Public Spaces Protection Order 2023

South Kesteven District Council (in this Order called “the Council”) in exercise of its powers under Section 59 of the Anti-social Behaviour, Crime and Policing Act 2014 (“the Act “) hereby makes the following Order:

The Order is made on the _____ and shall have effect for a period of 3 years thereafter, unless extended by further orders under the Council’s statutory powers.

General provisions:

1. This Order applies to land in the Restricted Areas specified in the Schedule to this Order.
2. The Council is satisfied that both of the conditions set out in Section 59 of the Act are satisfied, because the activity, identified in paragraph 5 of this Order, which is carried on in a public place (“the Restricted Area”) has a detrimental effect on the quality of life of those in the locality and this effect is or is likely to be of a persistent or continuing nature, such as to make the activity unreasonable and justifies the restrictions imposed by this Order.
3. The Order is available for inspection on the Council’s website and also by appointment, at the offices of South Kesteven District Council. Appointments can be made by contacting 01476 406080 or emailing neighbourhoods@southkesteven.gov.uk
4. If any interested person desires to question the validity of this Order on the grounds that the Council had no power to make it or that any requirement of the Act has not been complied with in relation to this Order, he or she may apply to the High Court within six weeks from the date on which this Order is made.

Prohibitions on persons with dogs under their control:

5. Dog Exclusion

A person in charge of a dog must not take it onto or permit the dog to enter or to remain on, any land specified in the Schedule to this Order unless -

- (a) he has reasonable excuse for failing to do so; or
- (b) the owner, occupier or other person or authority having control of the land has consented (generally or specifically) to his failing to do so.

Exemptions

Nothing in this Order shall apply to a disabled person (within the meaning of the Equality Act 2010) whose disability restricts his/her ability to comply with the Order and the dog is their guide dog or assistance dog

For the purpose of this Order:

- (a) Restricted Area means the land designated in the Schedule to this Order
- (b) A person who habitually has a dog in his possession shall be taken to be in charge of the dog at any time unless at that time some other person is in charge of the dog
- (c) An assistance dog, in general, is one that is trained to aid or assist a disabled person.
- (d) An "authorised officer" means an officer who is authorised in writing by the Council for the purposes of giving directions under the Order.

Penalty

A person who fails to comply with any obligation imposed by this Order is guilty of an offence and liable to a fine on summary conviction not exceeding level 3 on the standard scale.

An authorised officer may issue a fixed penalty notice (currently £100) to a person who they reasonably believe has breached the requirements of this Order. A fixed penalty notice offers the recipient the opportunity to discharge the liability to conviction for the offence by paying the fixed penalty notice within 14 days of issue of the notice.

Date Order Made:

Executed as a DEED by affixing the)
COMMON SEAL of SOUTH KESTEVEN)
DISTRICT COUNCIL)

In the presence of:

Schedule

This Order applies to all land within the administrative area of South Kesteven District Council and which is an enclosed children's play area detailed below and edged red in the attached plans.

Plan Number	Site Name
1	Gonerby Road, Grantham
2	Harrowby Lane, Grantham
3	Trent Road, Grantham
4	Wyndham Park, Hill Avenue, Grantham
5	Dysart Park, Bridge End Road, Grantham
6	Beechcroft Road, Grantham
7	Linchfield Road, Deeping St James
8	Crowson Way, Deeping St James
9	Church Street, Market Deeping
10	Godsey Lane, Market Deeping
11	Manor Lane, Bourne
12	Recreation Road, Bourne
13	Northfields, Bourne
14	Manor Close, Langtoft
15	Blackbull Green, Stowe Road, Langtoft
16	Recreation Ground Road, Stamford
17	Drift Road, Stamford
18	Elizabeth Road, Stamford
19	Water Lane, South Witham
20	Honington Road, Barkston
21	Village Hall, Main Road, Dowsby
22	Bottesford Road, Allington
23	Braceby Road, Ropsley
24	Carlton Road, Hough on the Hill
25	Main Street, Woolsthorpe by Belvoir
26	Colster Way, Colsterworth
27	Woolsthorpe Road, Woolsthorpe by Colsterworth
28	Lawrance Park, Crown Lane, Thurlby
29	Belton Lane, Great Gonerby
30	Arnoldfield, Gonerby Road, Grantham
31	Princess Drive, Grantham
32	Elgar Way, Stamford
33	Pinewood Close, Bourne
34	Churchfield Close, Deeping St James
35	Hereward Way, Deeping St James
36	Wellington Way, Market Deeping

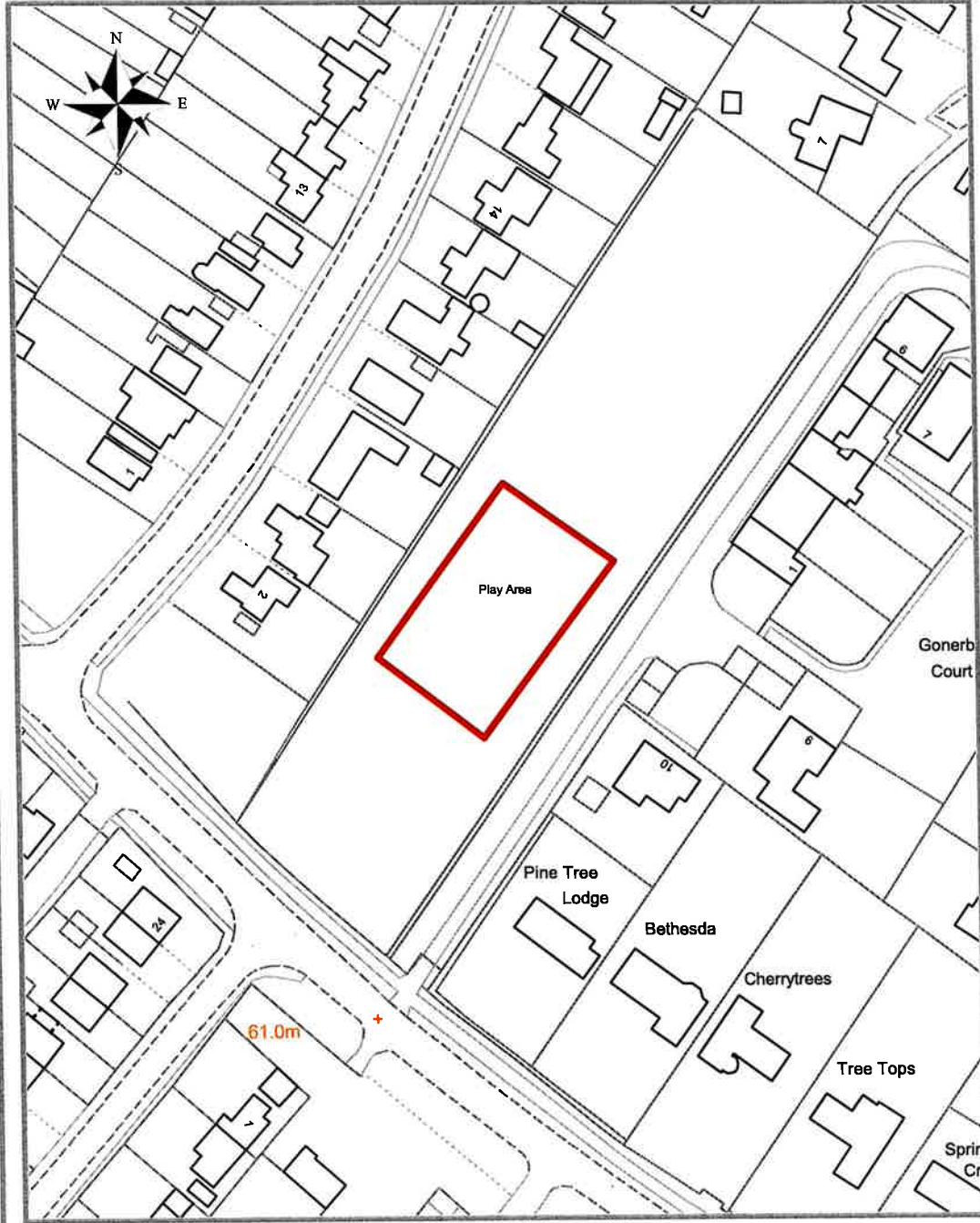

Enclosed play area

Gonerby Road,
Grantham

For identification purposes only



SOUTH
KESTEVEN
DISTRICT
COUNCIL

Plan 2

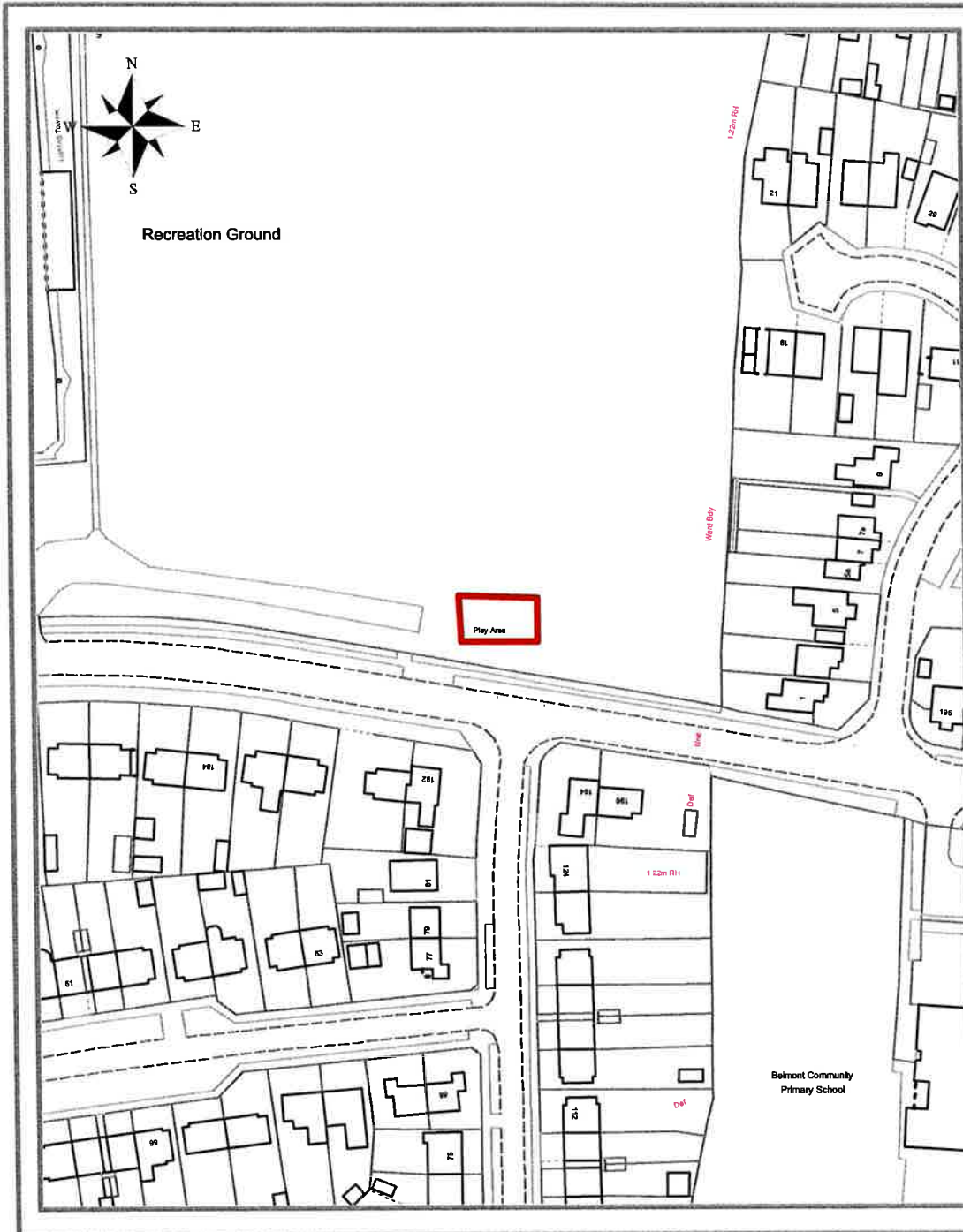

Enclosed play area

Harrowby Lane, Grantham

For identification purposes only



SOUTH KESTEVEN DISTRICT COUNCIL

© Crown copyright and database rights 2020 Ordnance Survey 100018662



Enclosed play area

Trent Road,
Grantham

For identification purposes only



SOUTH
KESTEVEN
DISTRICT
COUNCIL

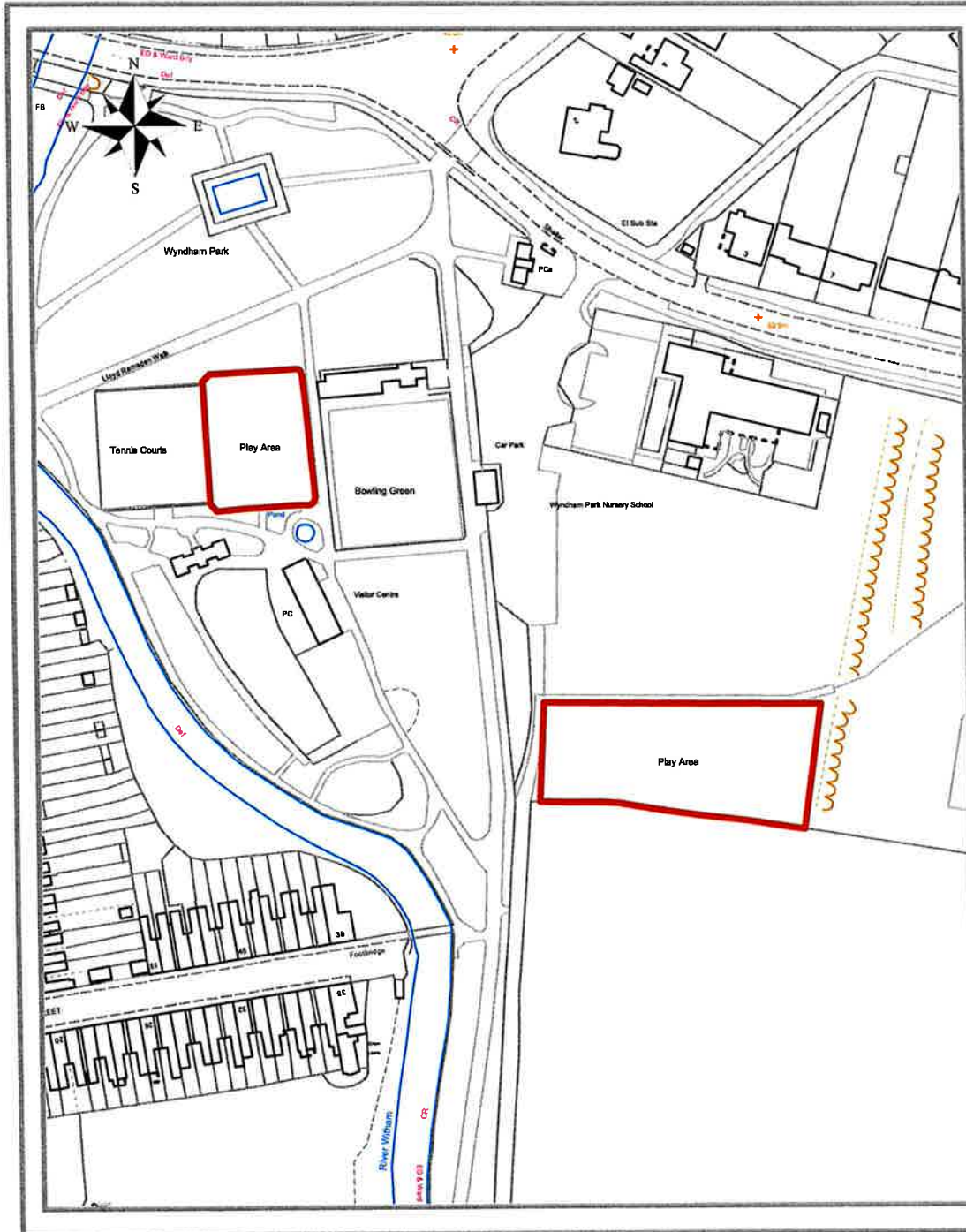

Enclosed play area

Wyndham Park and
Hill Avenue,
Grantham

For identification purposes only



SOUTH
KESTEVEN
DISTRICT
COUNCIL

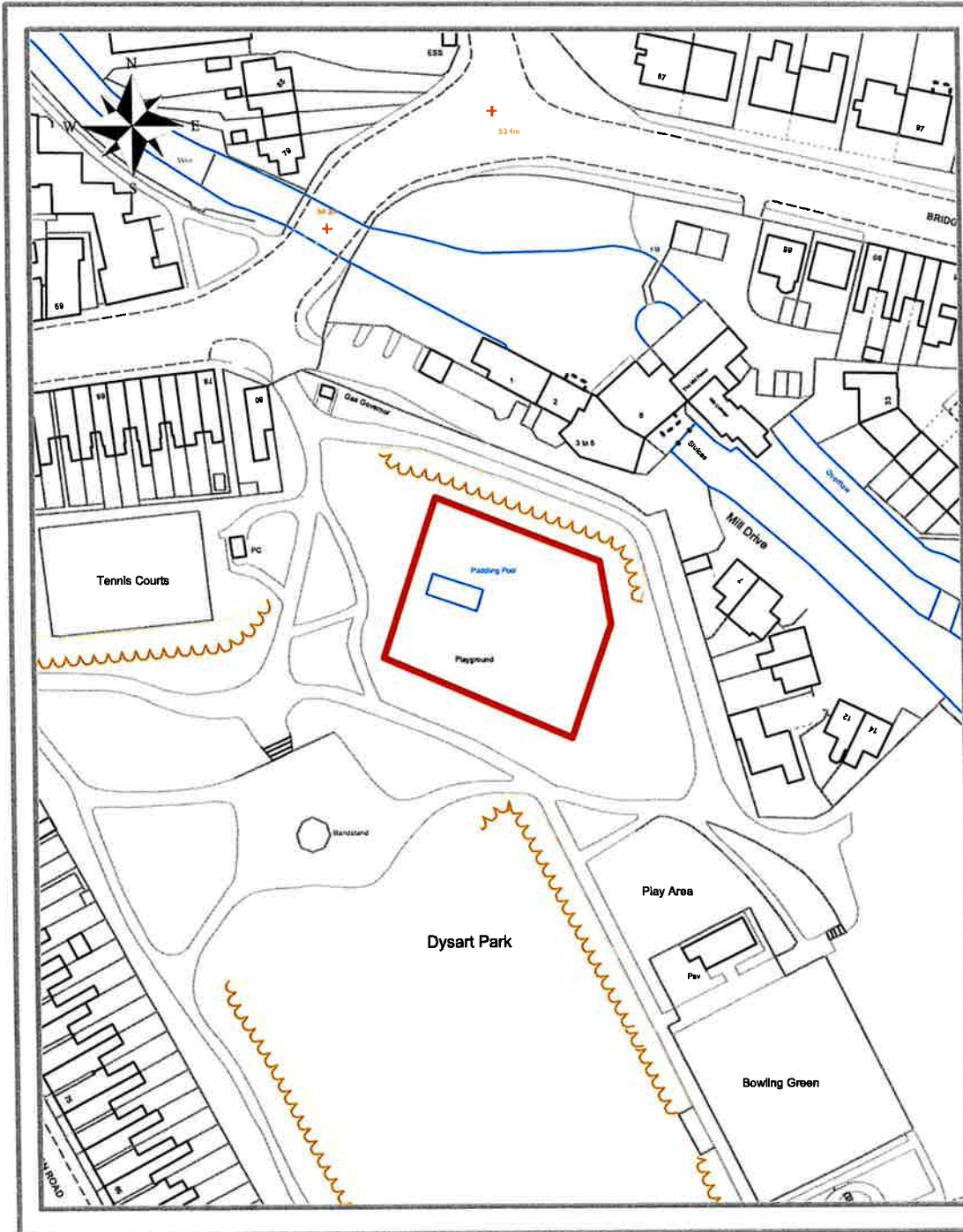

Enclosed play area

Dysart Park,
Bridge End Road,
Grantham

For identification purposes only



SOUTH
KESTEVEN
DISTRICT
COUNCIL

Plan 6

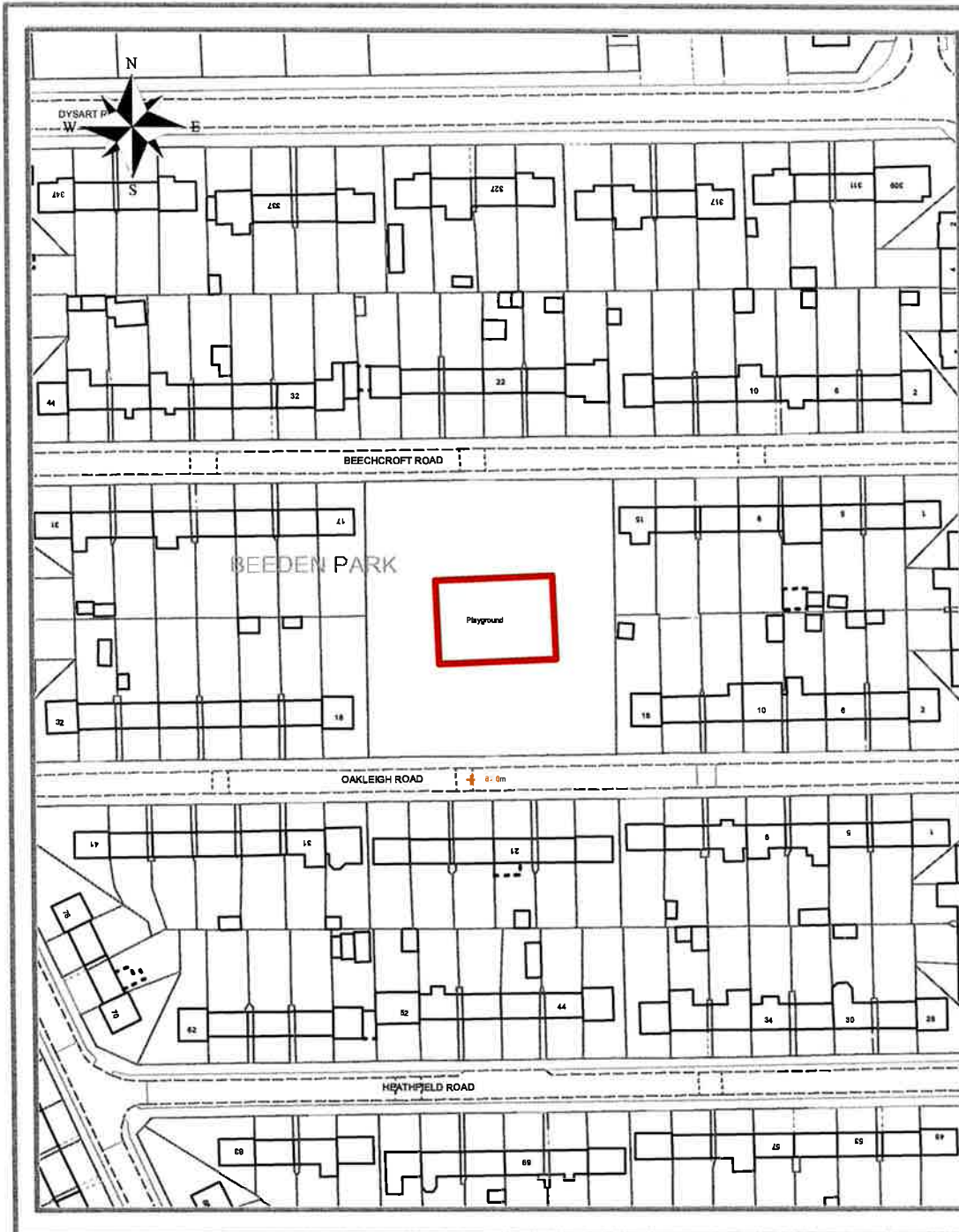

Enclosed play area

Beechcroft Road,
Grantham

For identification purposes only



SOUTH
KESTEVEN
DISTRICT
COUNCIL



Enclosed play area

Linchfield Road,
Deeping St. James

For identification purposes only



SOUTH
KESTEVEN
DISTRICT
COUNCIL

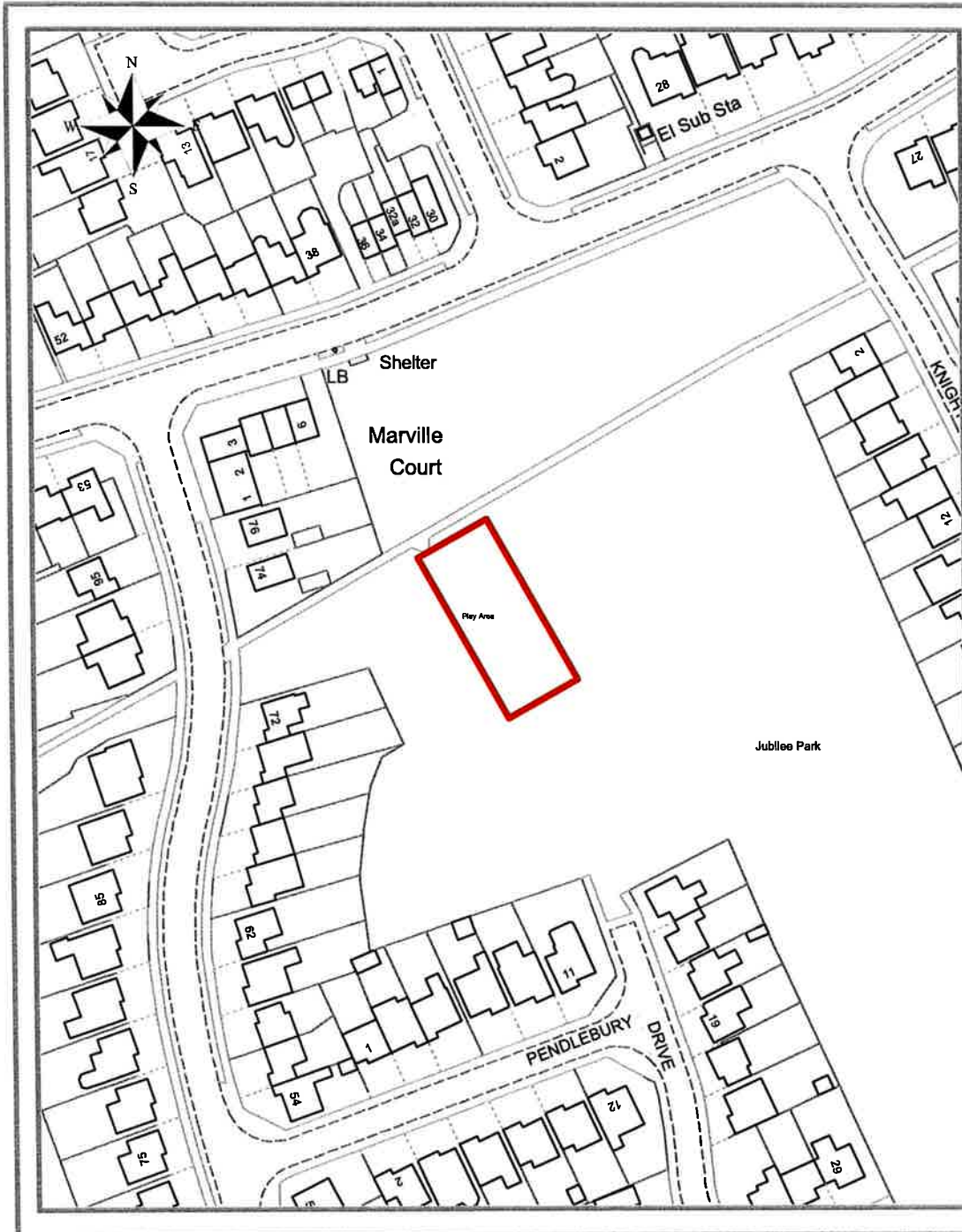

Enclosed play area

Crowson Way,
Deeping St. James

For identification purposes only



SOUTH
KESTEVEN
DISTRICT
COUNCIL



Enclosed play area

Church Street,
Market Deeping

For identification purposes only



SOUTH
KESTEVEN
DISTRICT
COUNCIL

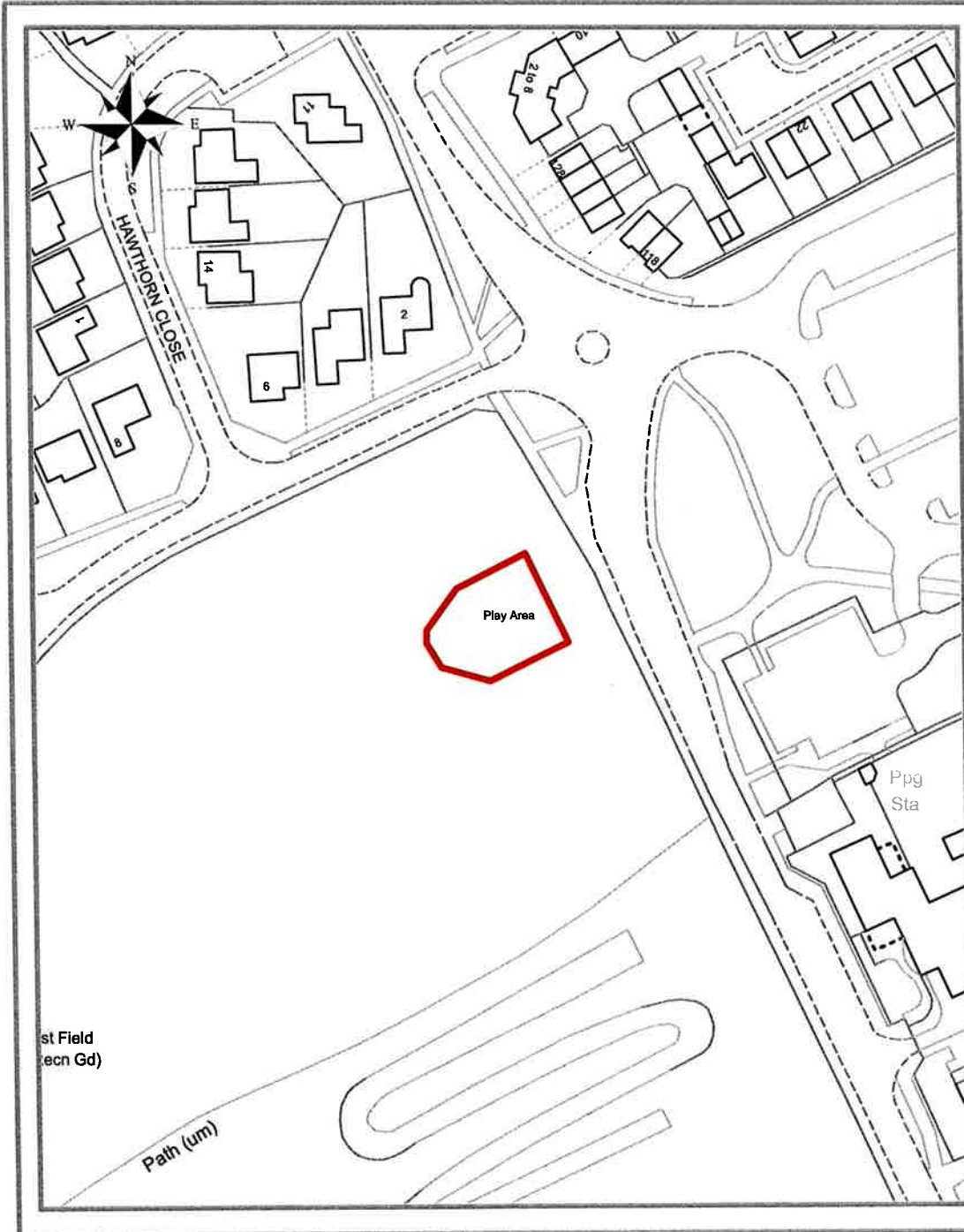

Enclosed play area

**Godsey Lane,
Market Deeping**

For identification purposes only



**SOUTH
KESTEVEN
DISTRICT
COUNCIL**

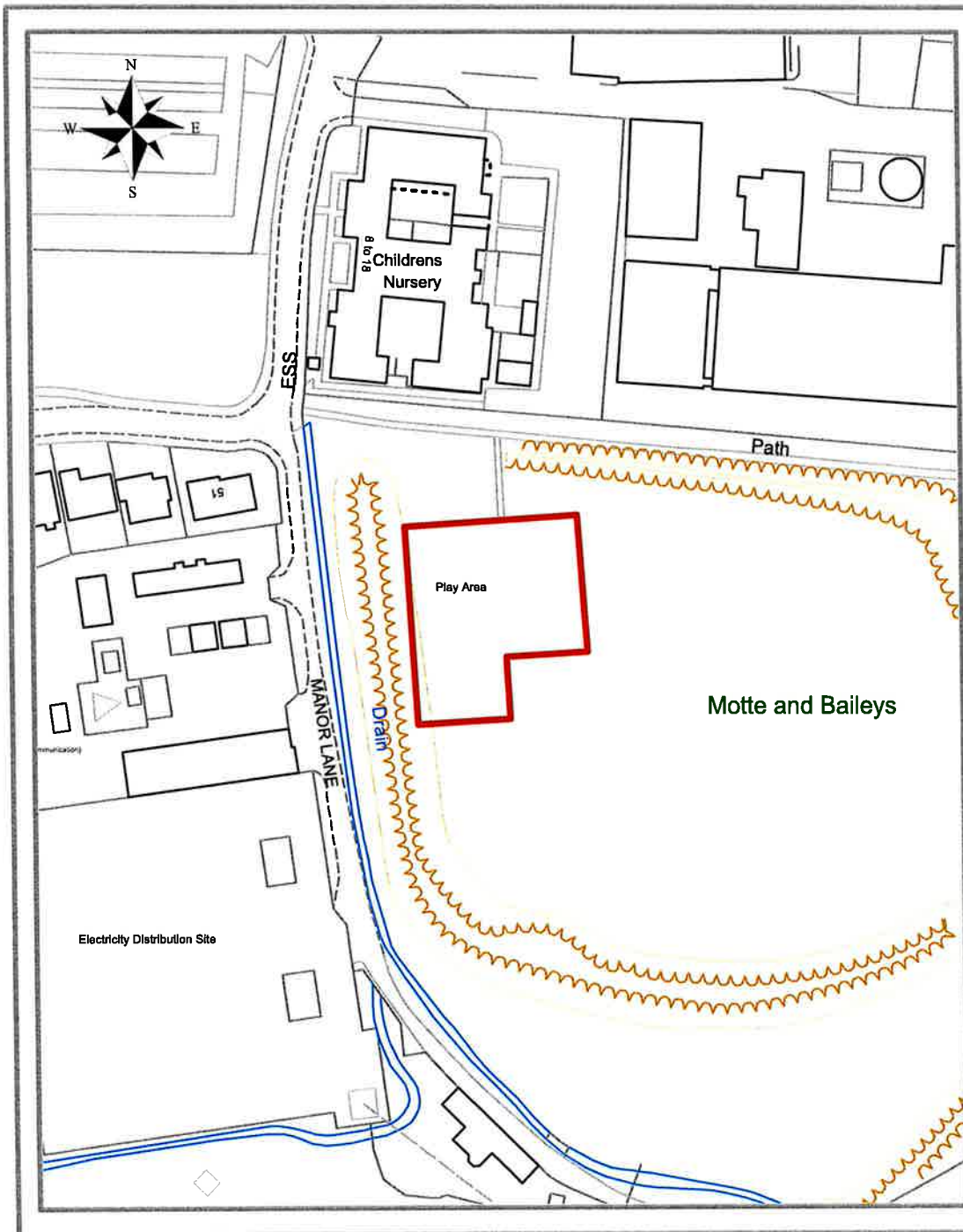

Enclosed play area

Manor Lane,
Bourne

For identification purposes only



SOUTH
KESTEVEN
DISTRICT
COUNCIL

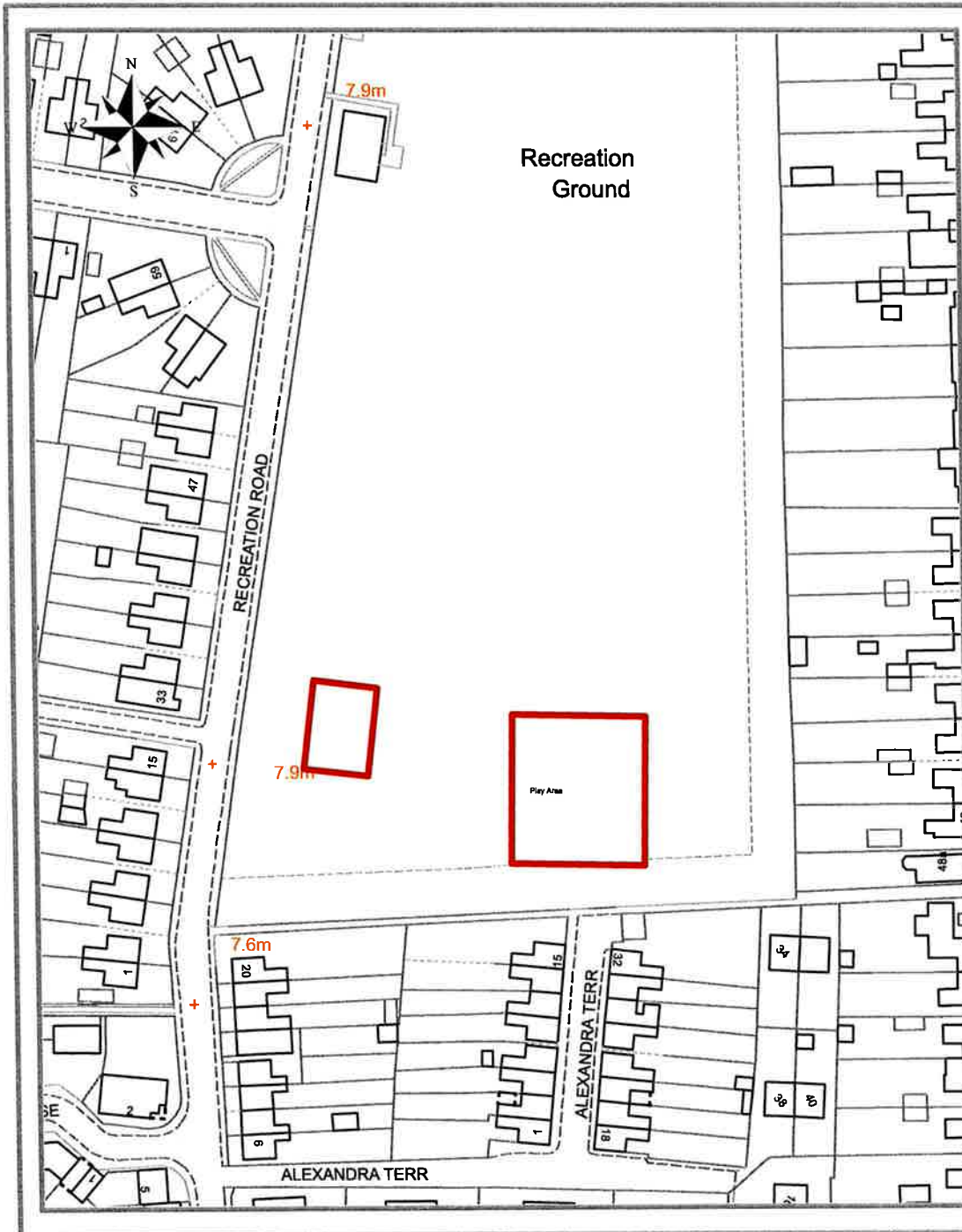

Enclosed play area

Recreation Road,
Bourne

For identification purposes only



SOUTH
KESTEVEN
DISTRICT
COUNCIL



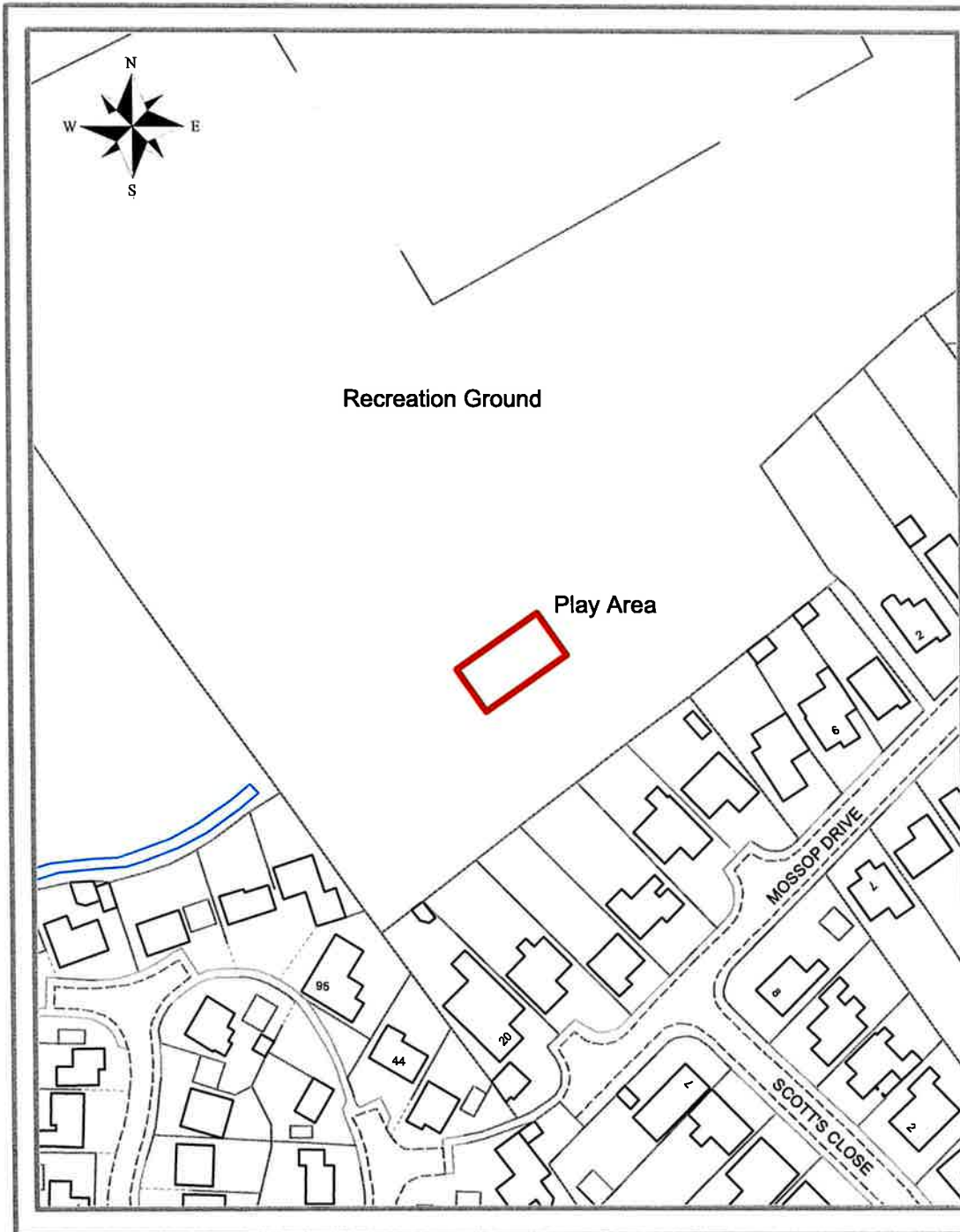

Enclosed play area

**Manor Close,
Langtoft**

For identification purposes only



**SOUTH
KESTEVEN
DISTRICT
COUNCIL**

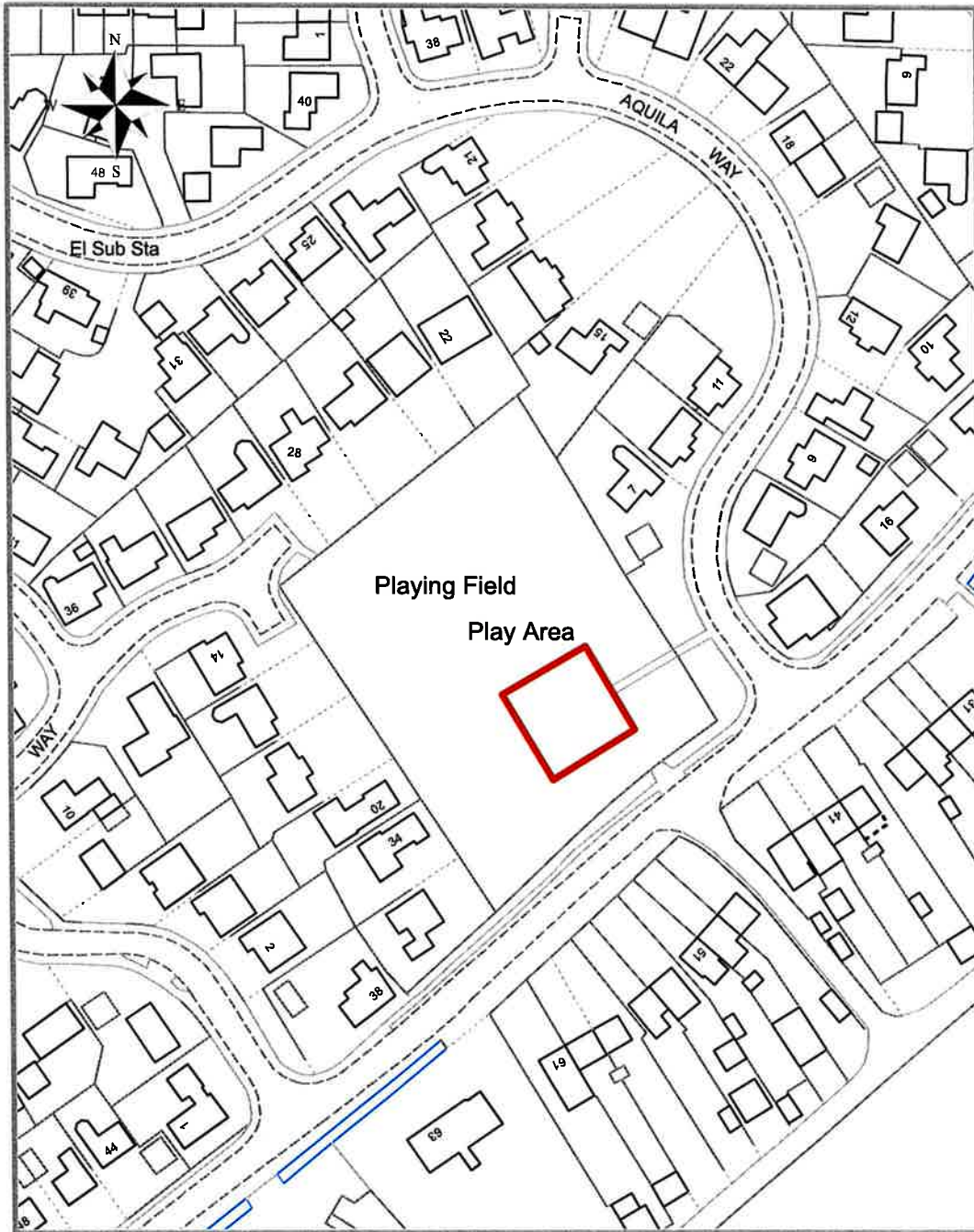

Enclosed play area

**Blackbull Green,
Stowe Road,
Langtoft**

For identification purposes only



**SOUTH
KESTEVEN
DISTRICT
COUNCIL**

Plan 16



SOUTH
KESTEVEN
DISTRICT
COUNCIL



SOUTH
KESTEVEN
DISTRICT
COUNCIL

Recreation Ground, Stamford

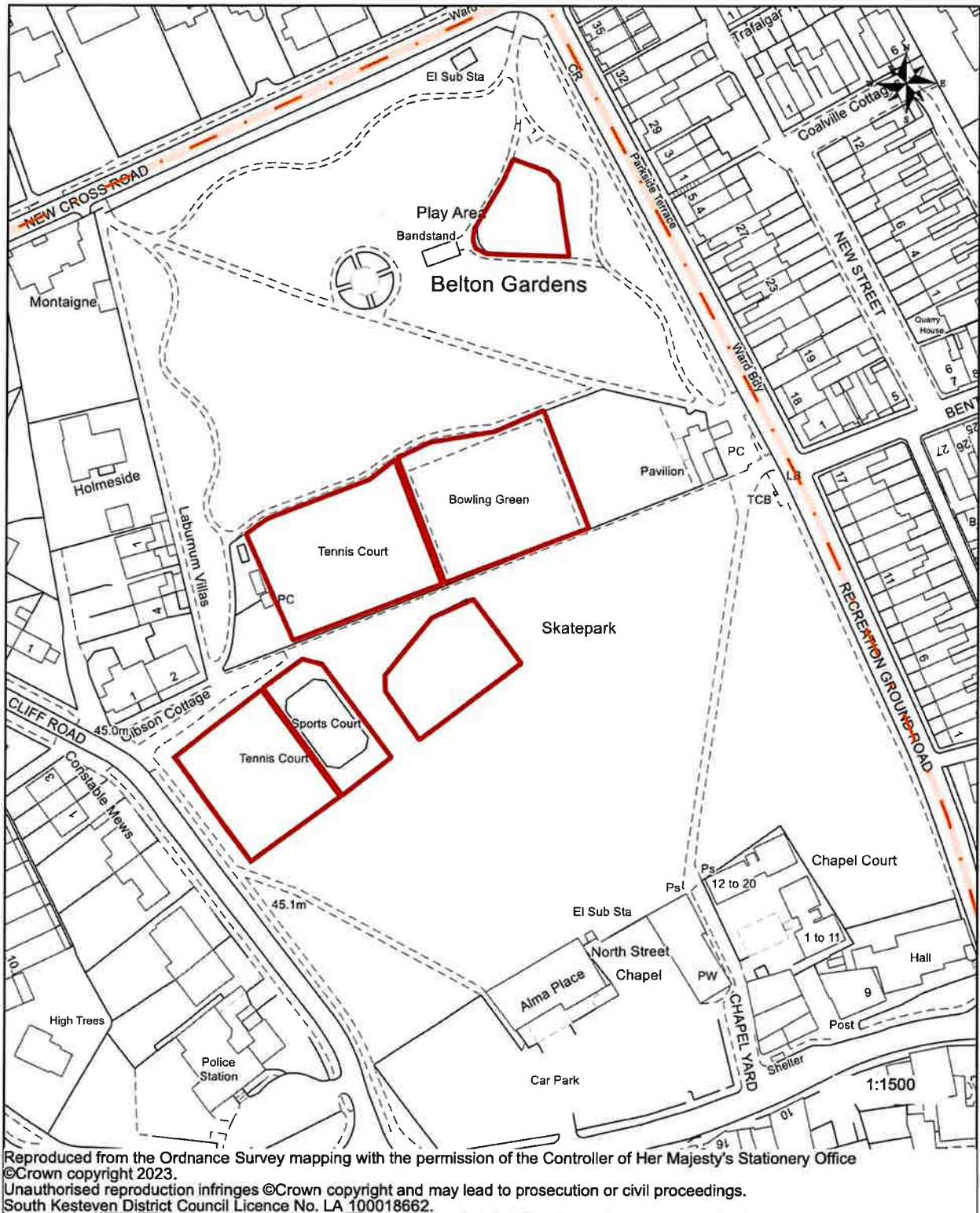



Enclosed play area

Drift Road,
Stamford

For identification purposes only



SOUTH
KESTEVEN
DISTRICT
COUNCIL



Enclosed play area

Elizabeth Road,
Stamford

For identification purposes only



SOUTH
KESTEVEN
DISTRICT
COUNCIL

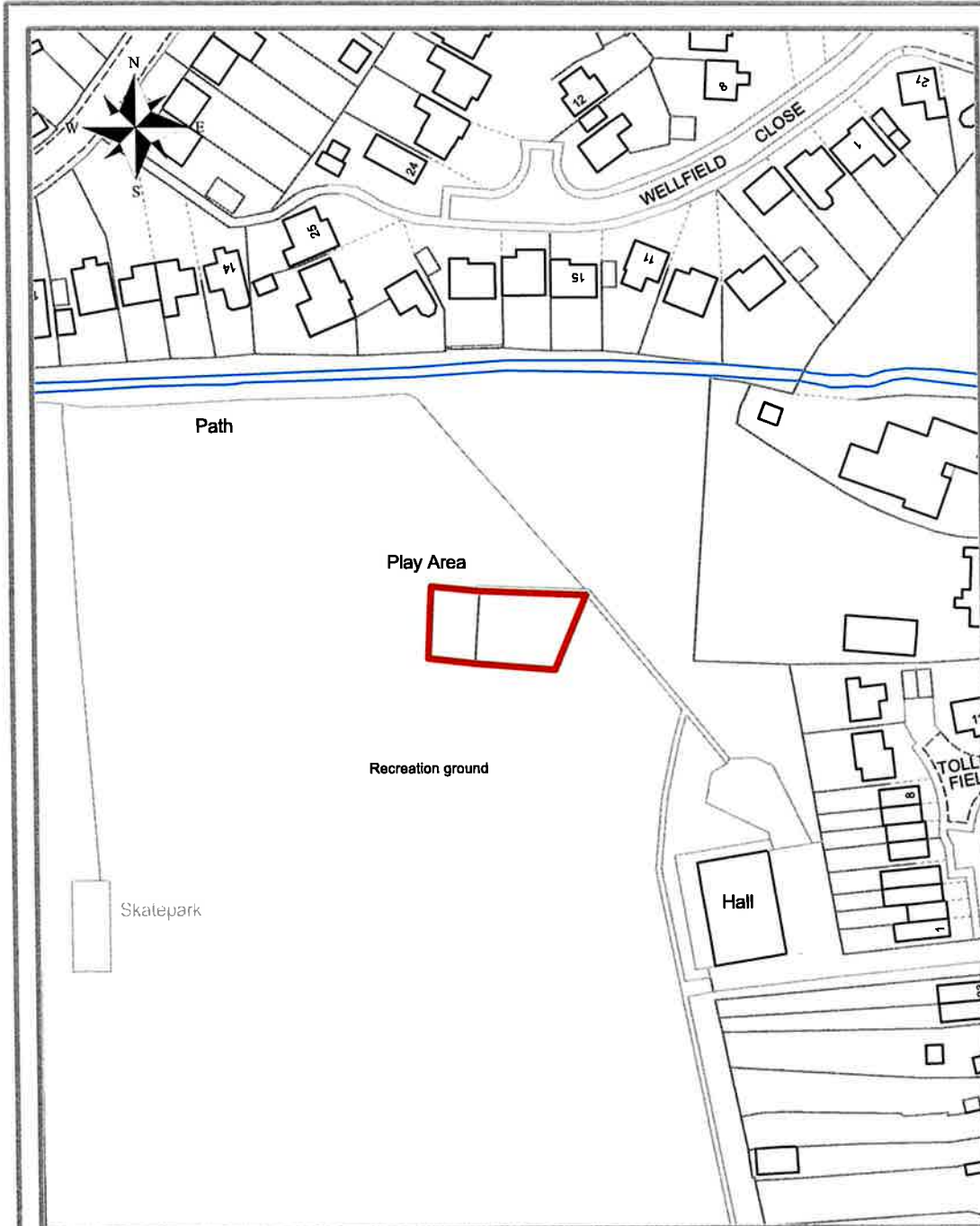

Enclosed play area

**Water Lane,
South Witham**

For identification purposes only



**SOUTH
KESTEVEN
DISTRICT
COUNCIL**

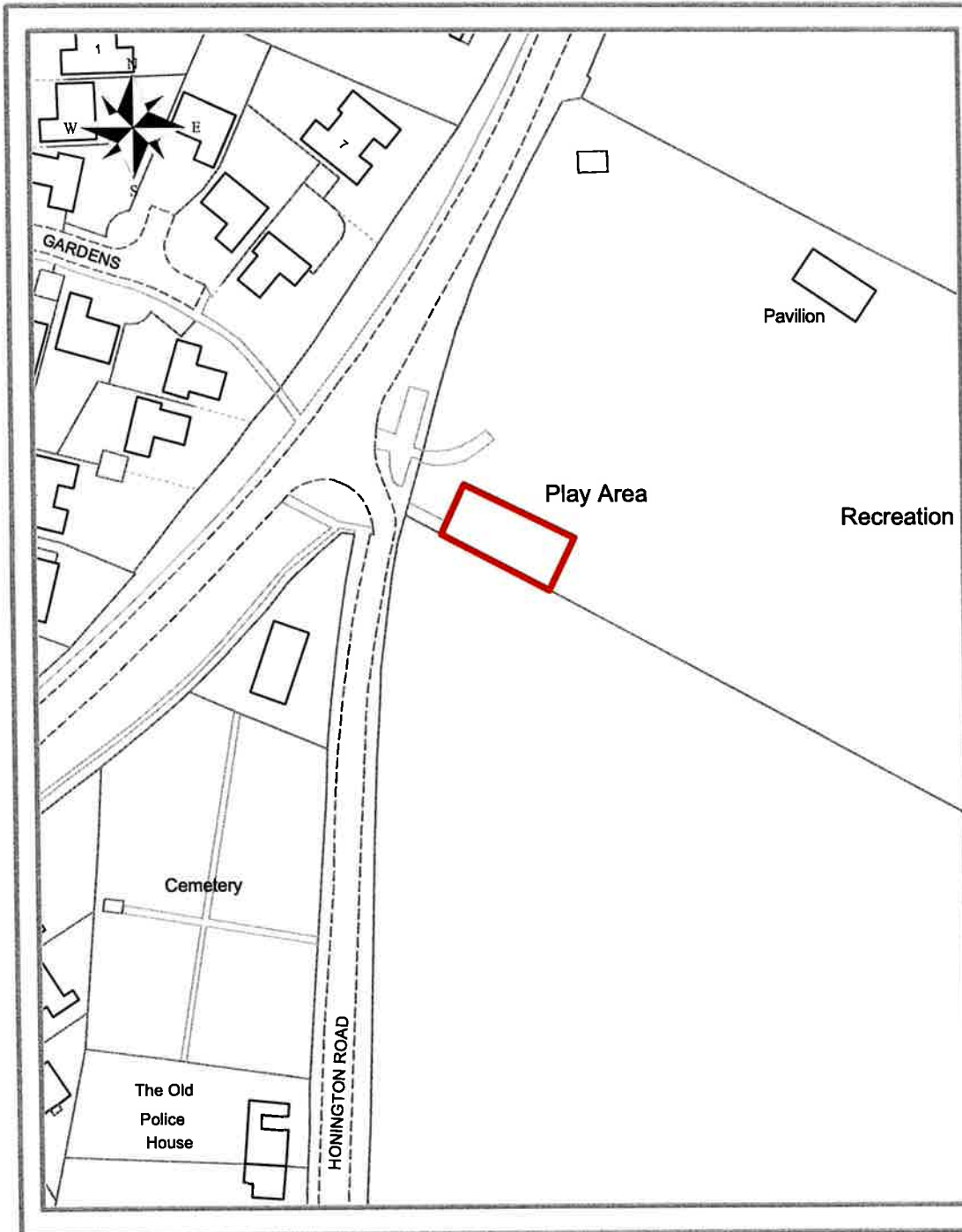

Enclosed play area

Honington Road,
Barkston

For identification purposes only



SOUTH
KESTEVEN
DISTRICT
COUNCIL

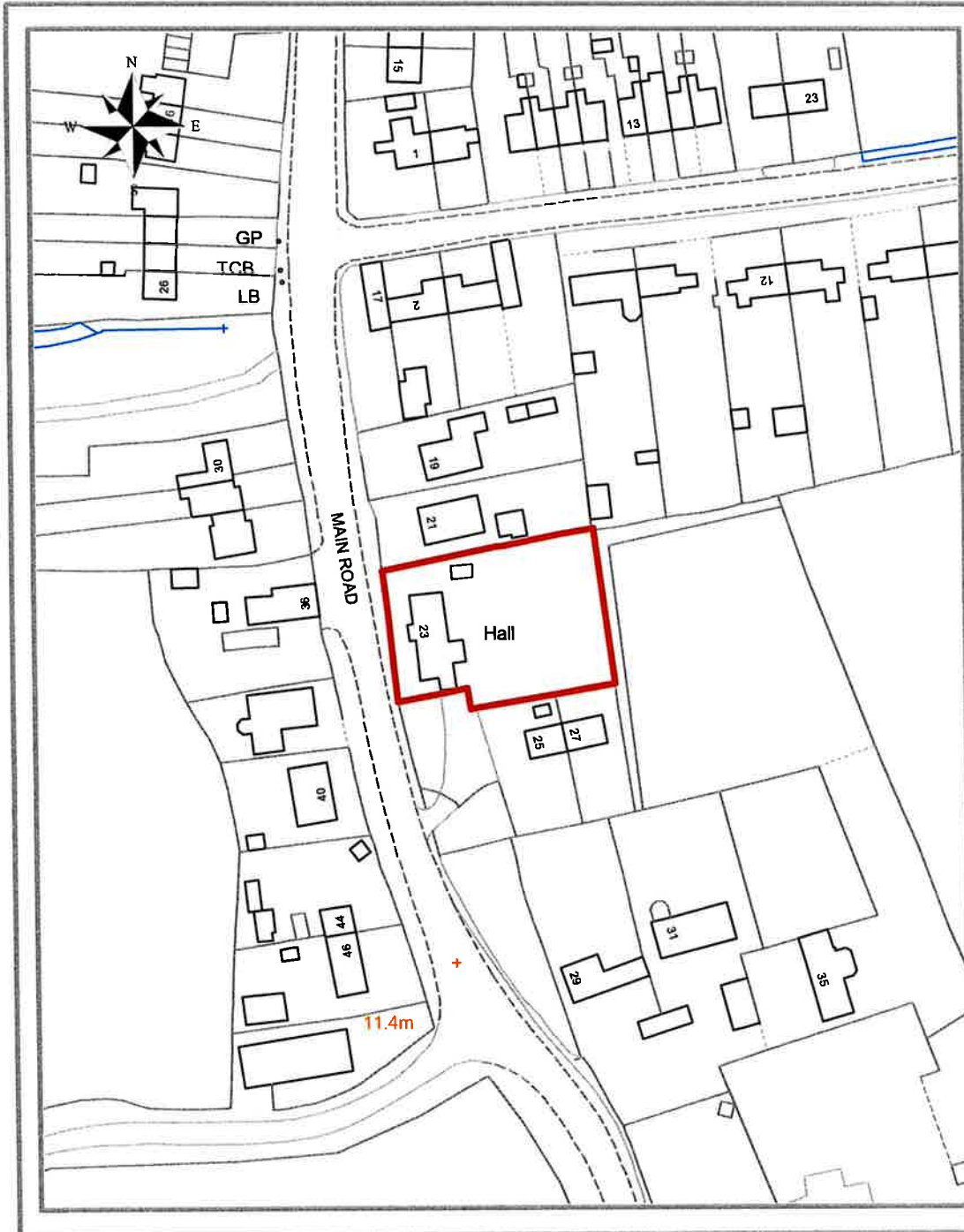

Enclosed play area

Village Hall,
Main Road,
Dowsby

For identification purposes only



**SOUTH
KESTEVEN
DISTRICT
COUNCIL**

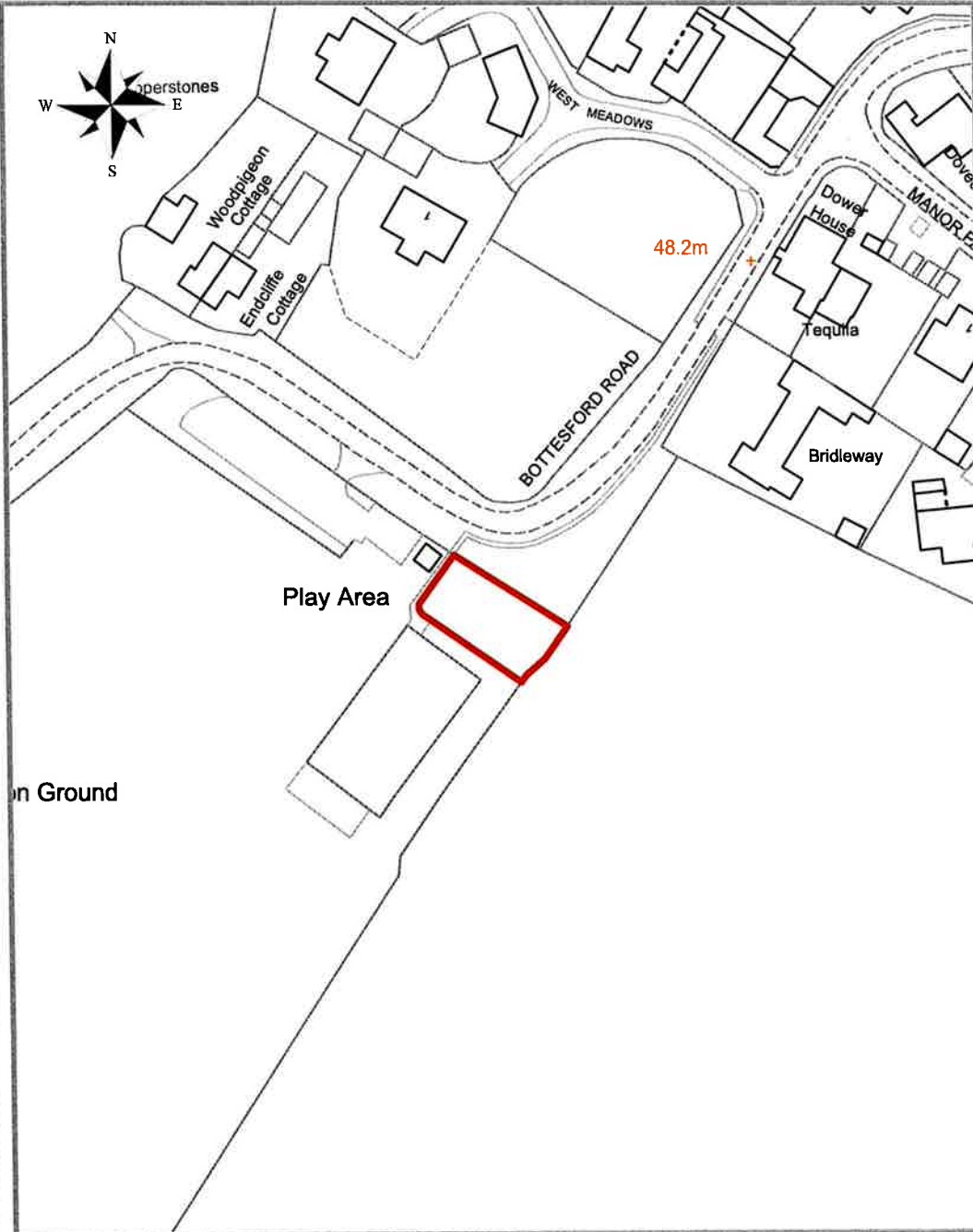

Enclosed play area

Bottesford Road,
Allington

For identification purposes only



SOUTH
KESTEVEN
DISTRICT
COUNCIL

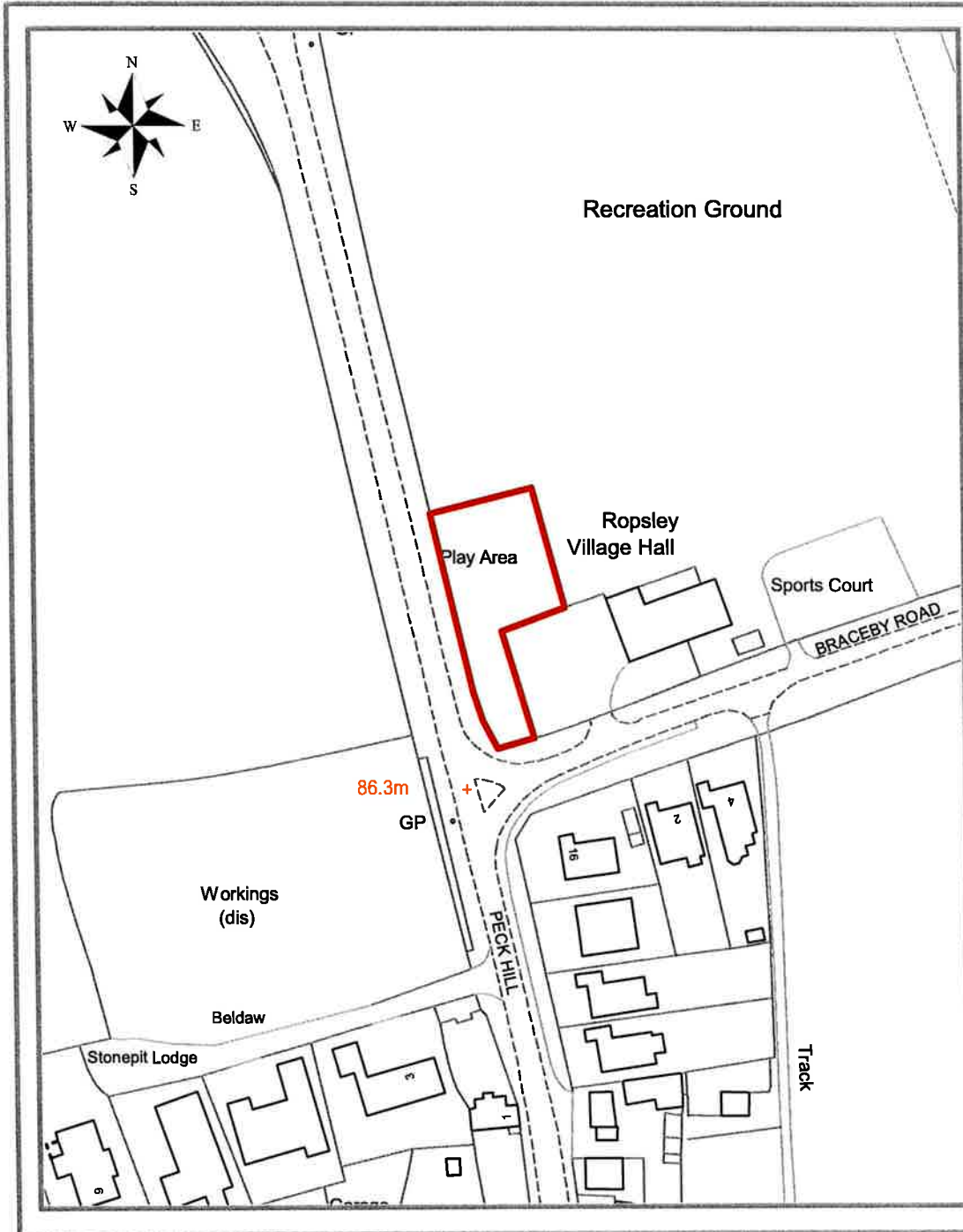

Enclosed play area

Braceby Road, Ropsley

For identification purposes only



**SOUTH
KESTEVEN
DISTRICT
COUNCIL**

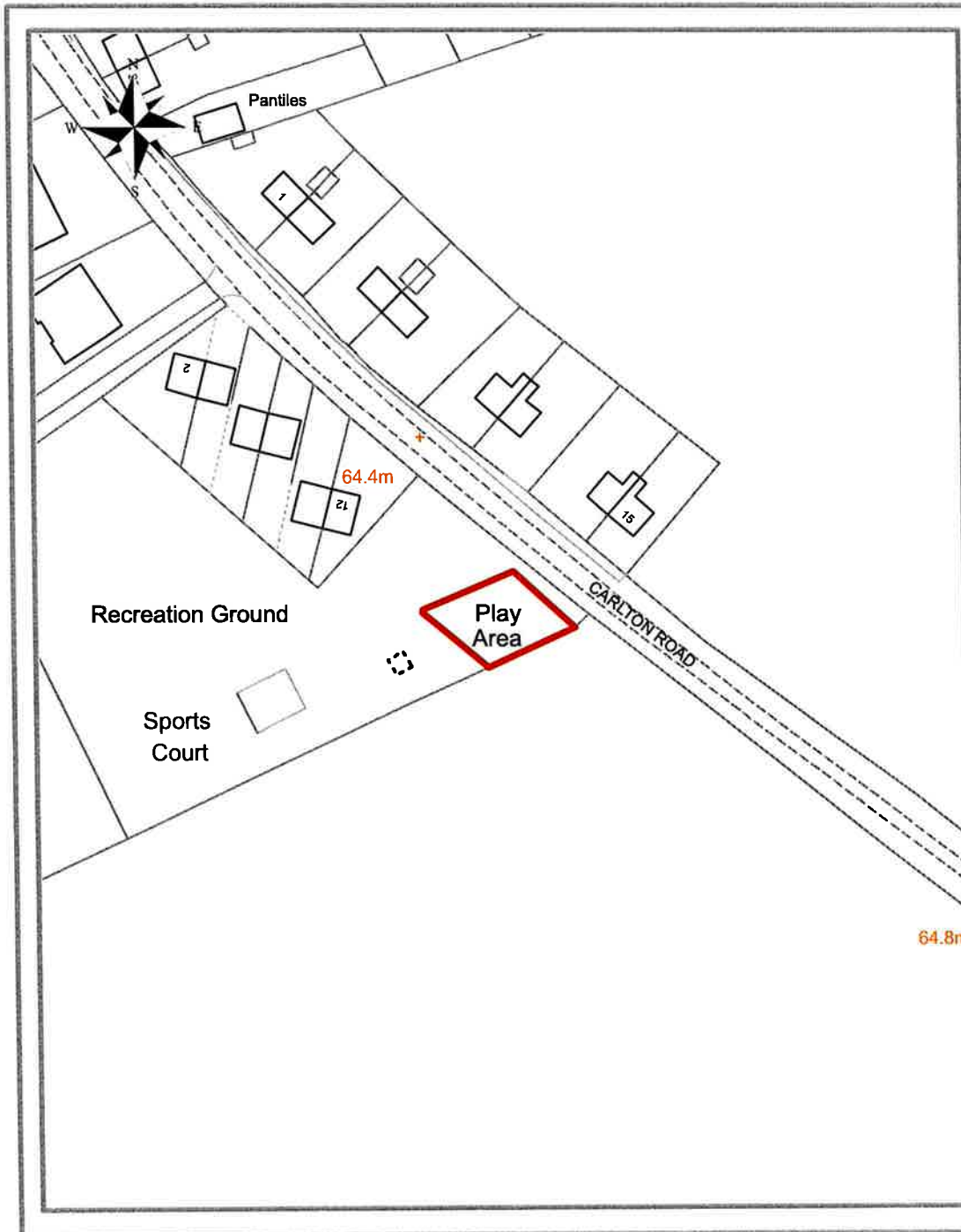

Enclosed play area

Carlton Road, Hough on the Hill

For identification purposes only



SOUTH KESTEVEN DISTRICT COUNCIL

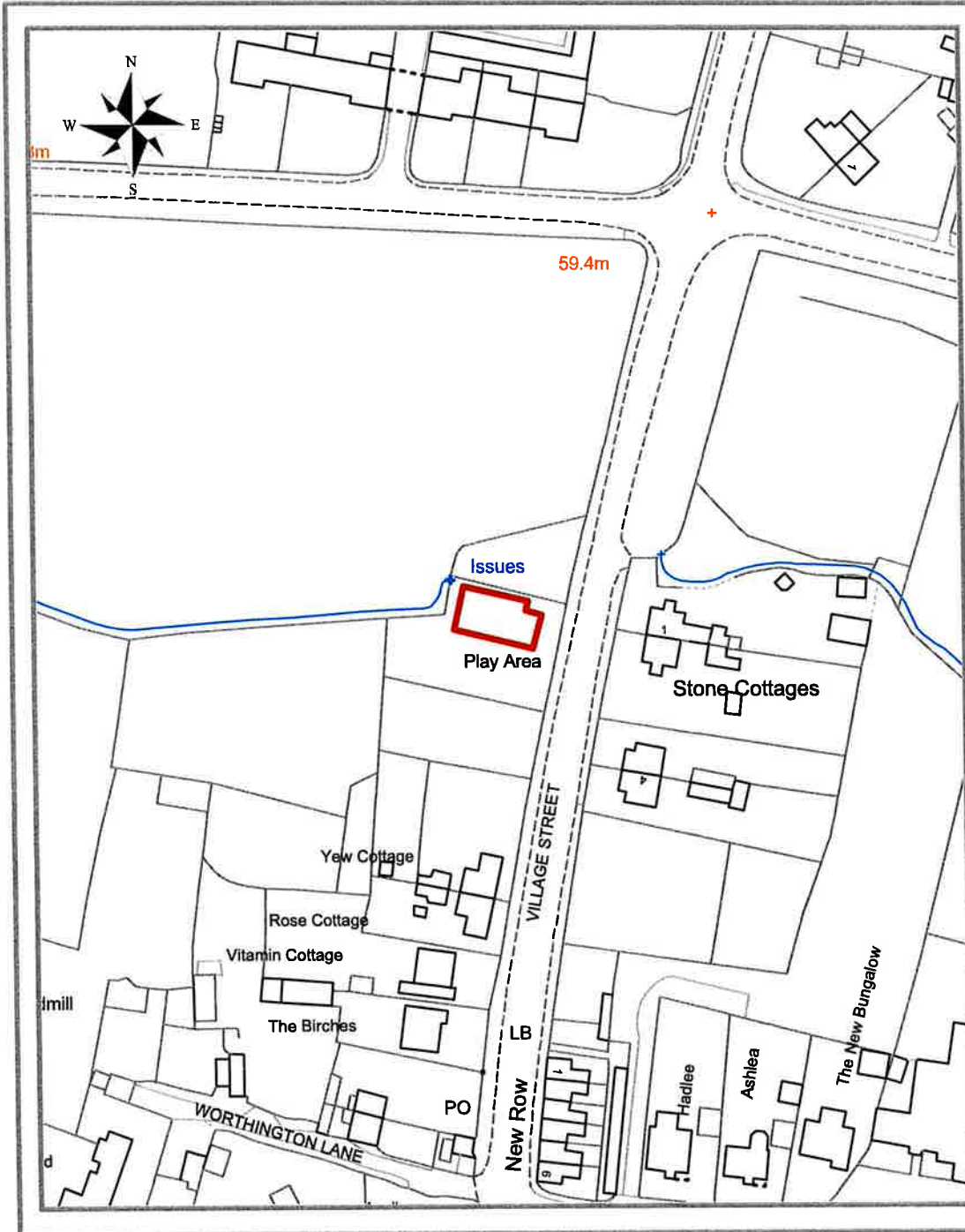

Enclosed play area

Main Street, Woolsthorpe by Belvoir

For identification purposes only



**SOUTH
KESTEVEN
DISTRICT
COUNCIL**

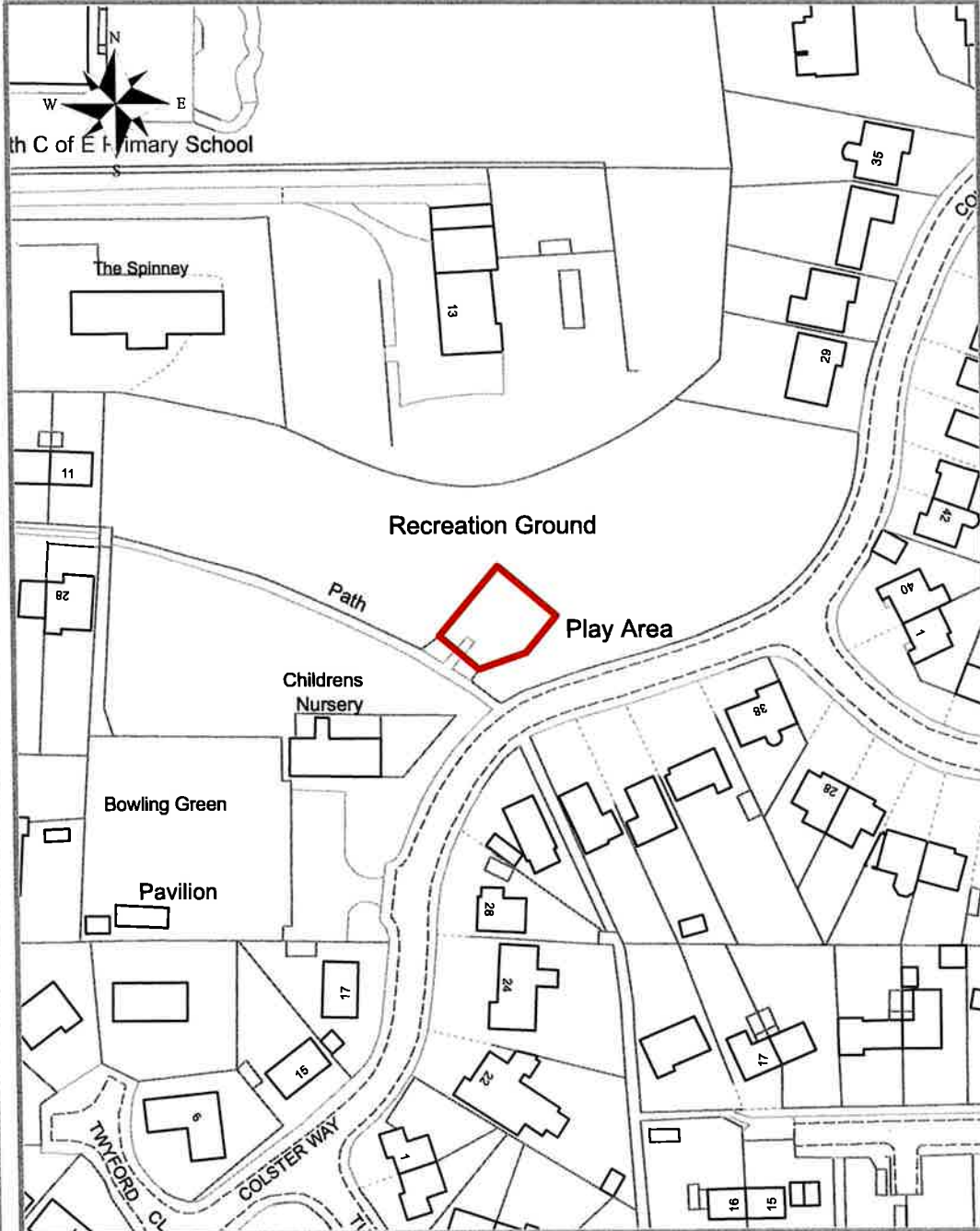

Enclosed play area

Colster Way,
Colsterworth

For identification purposes only



SOUTH
KESTEVEN
DISTRICT
COUNCIL

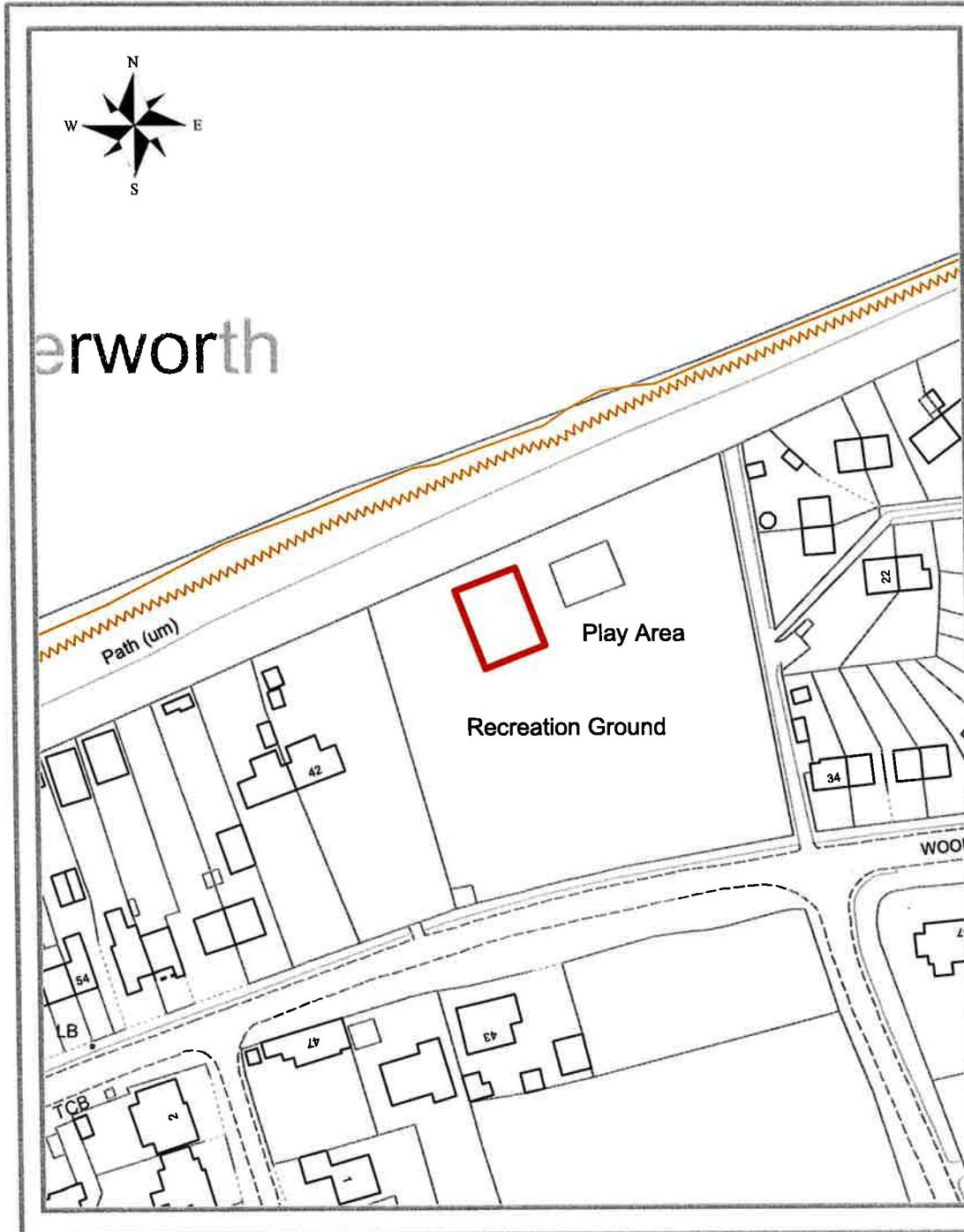

Enclosed play area

Woolsthorpe Road,
Woolsthorpe by
Colsterworth

For identification purposes only



SOUTH
KESTEVEN
DISTRICT
COUNCIL

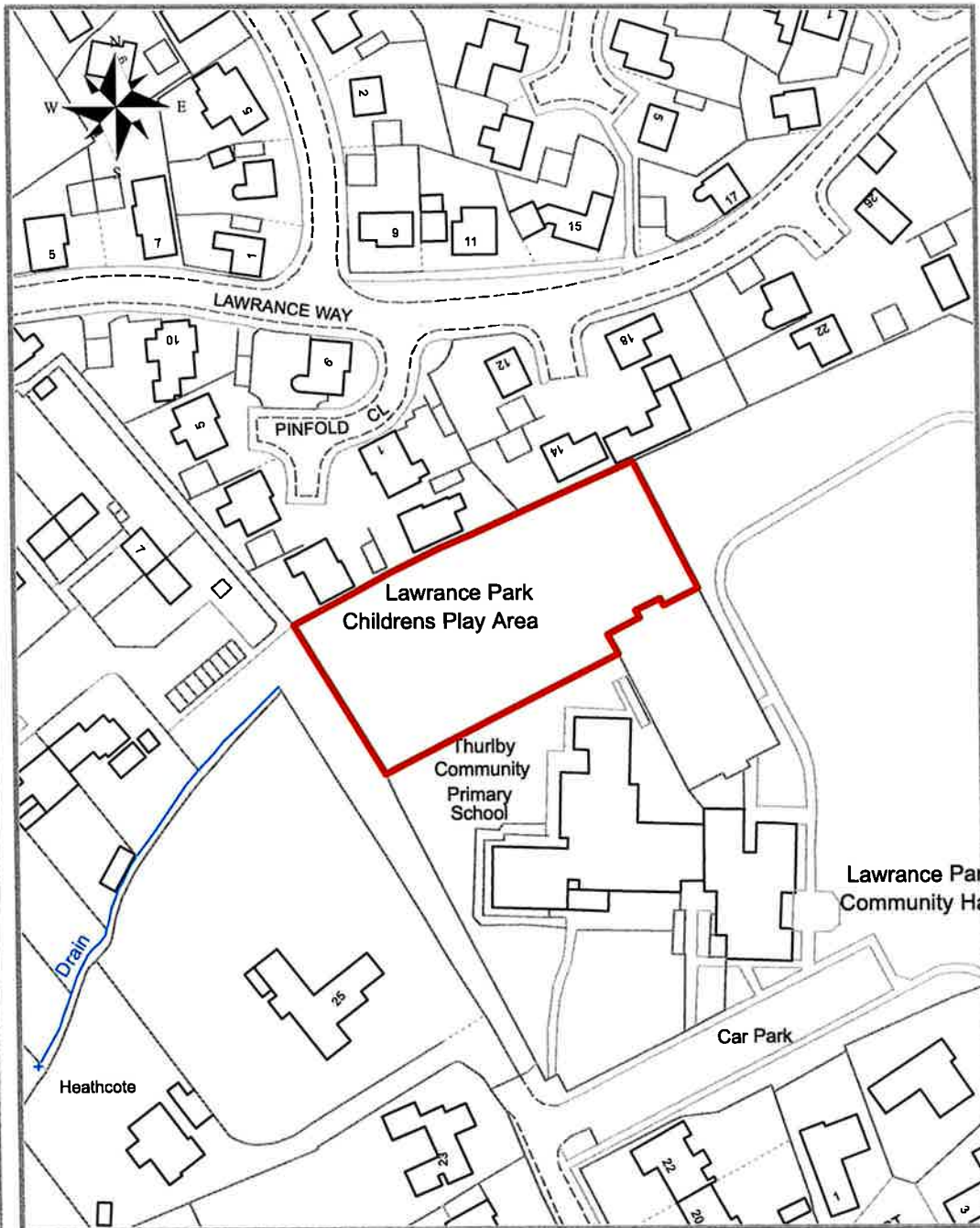

Enclosed play area

**Lawrance Park,
Crown Lane,
Thurlby**

For identification purposes only



**SOUTH
KESTEVEN
DISTRICT
COUNCIL**

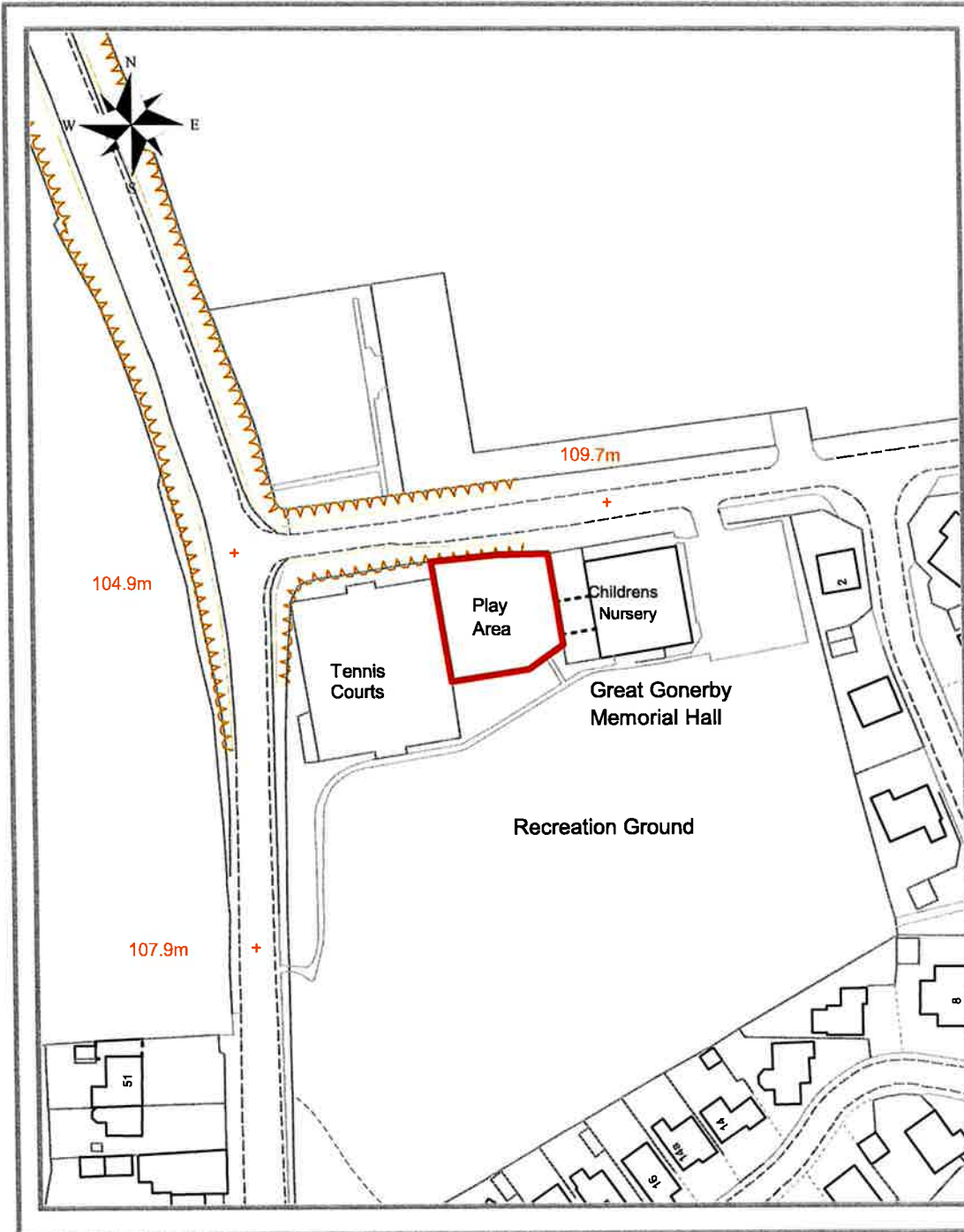

Enclosed play area

Belton Lane, Great Gonerby

For identification purposes only



**SOUTH
KESTEVEN
DISTRICT
COUNCIL**

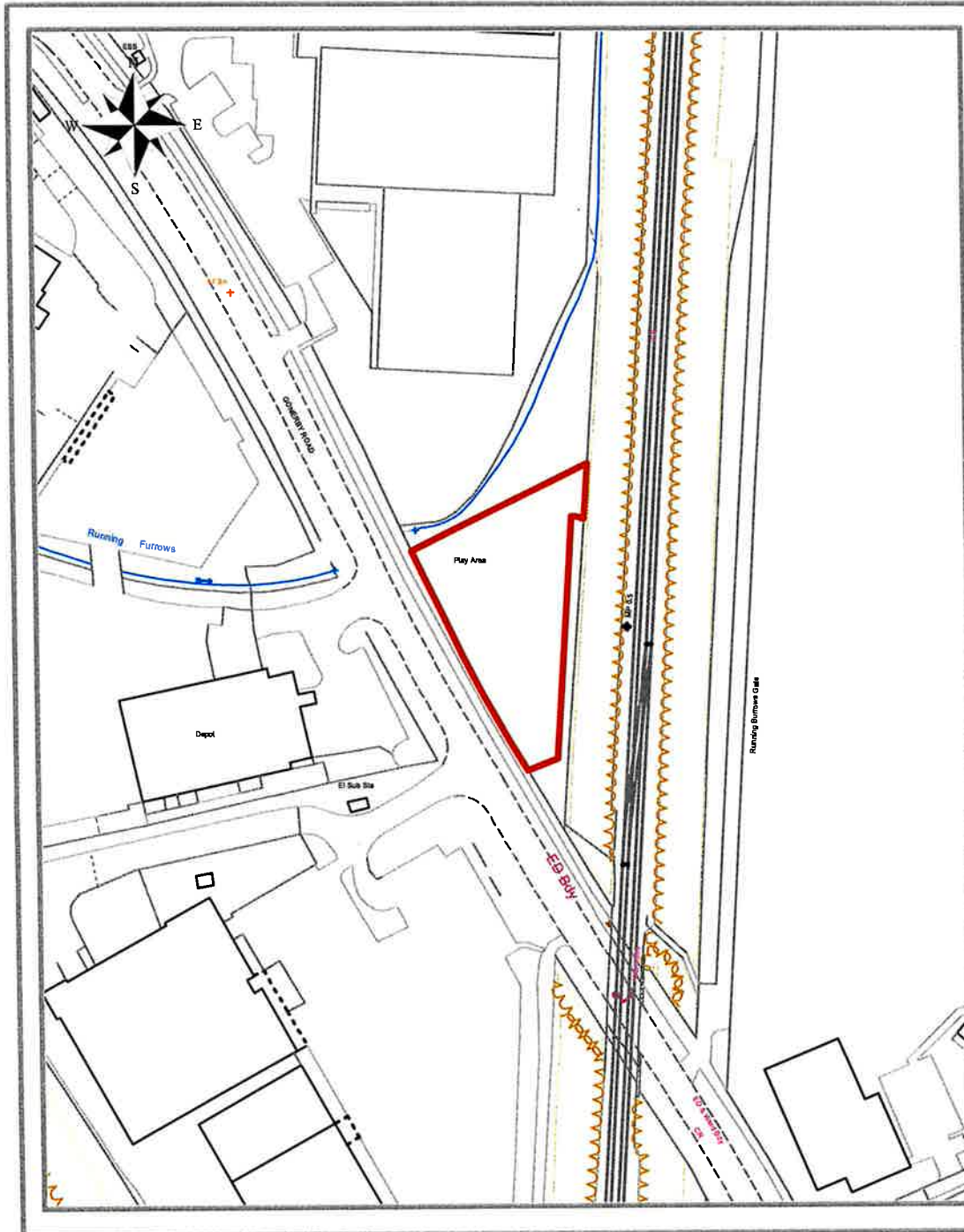

Enclosed play area

Arnoldfield,
Gonerby Road,
Grantham

For identification purposes only



SOUTH
KESTEVEN
DISTRICT
COUNCIL

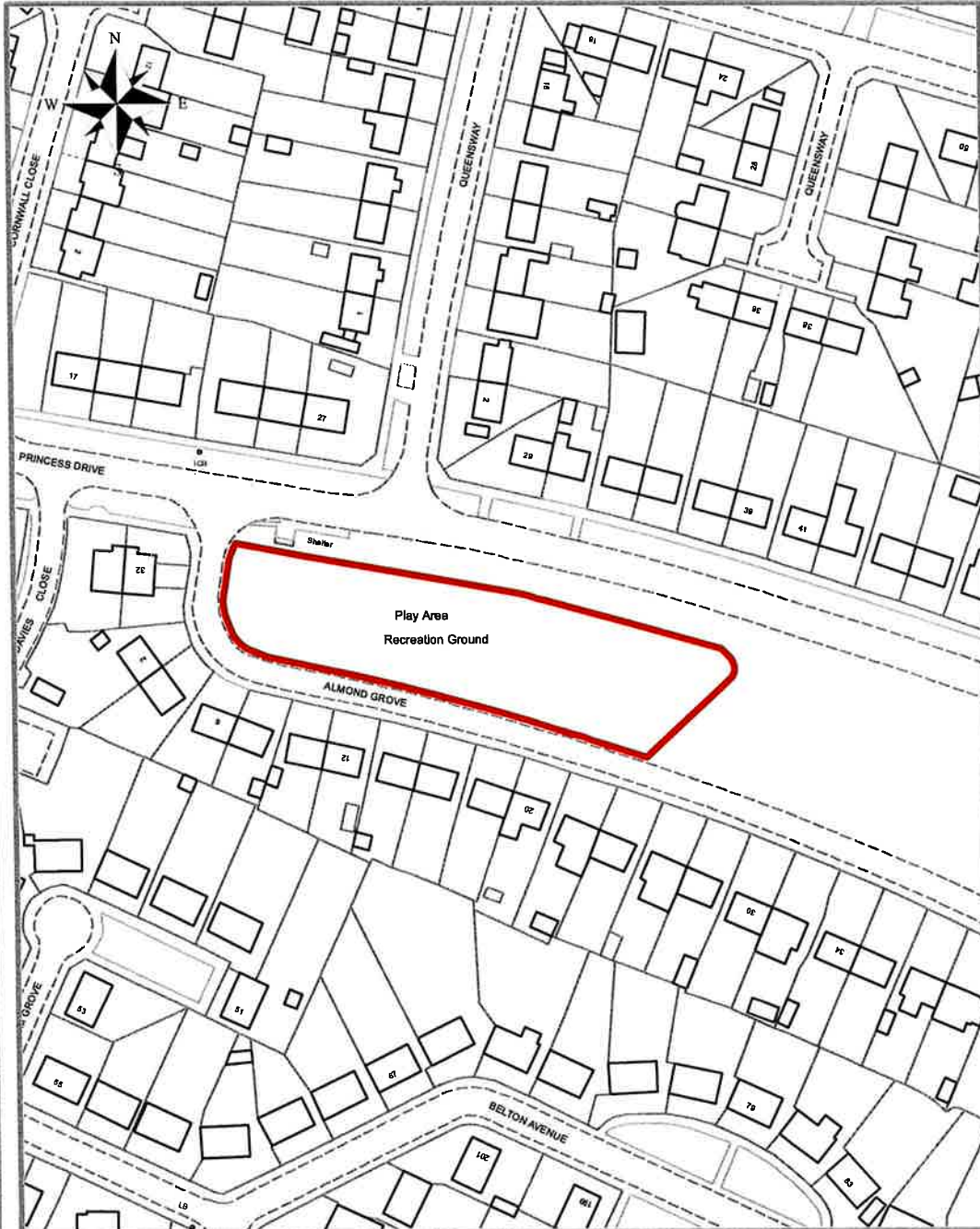

Enclosed play area

Princess Drive,
Grantham

For identification purposes only



SOUTH
KESTEVEN
DISTRICT
COUNCIL

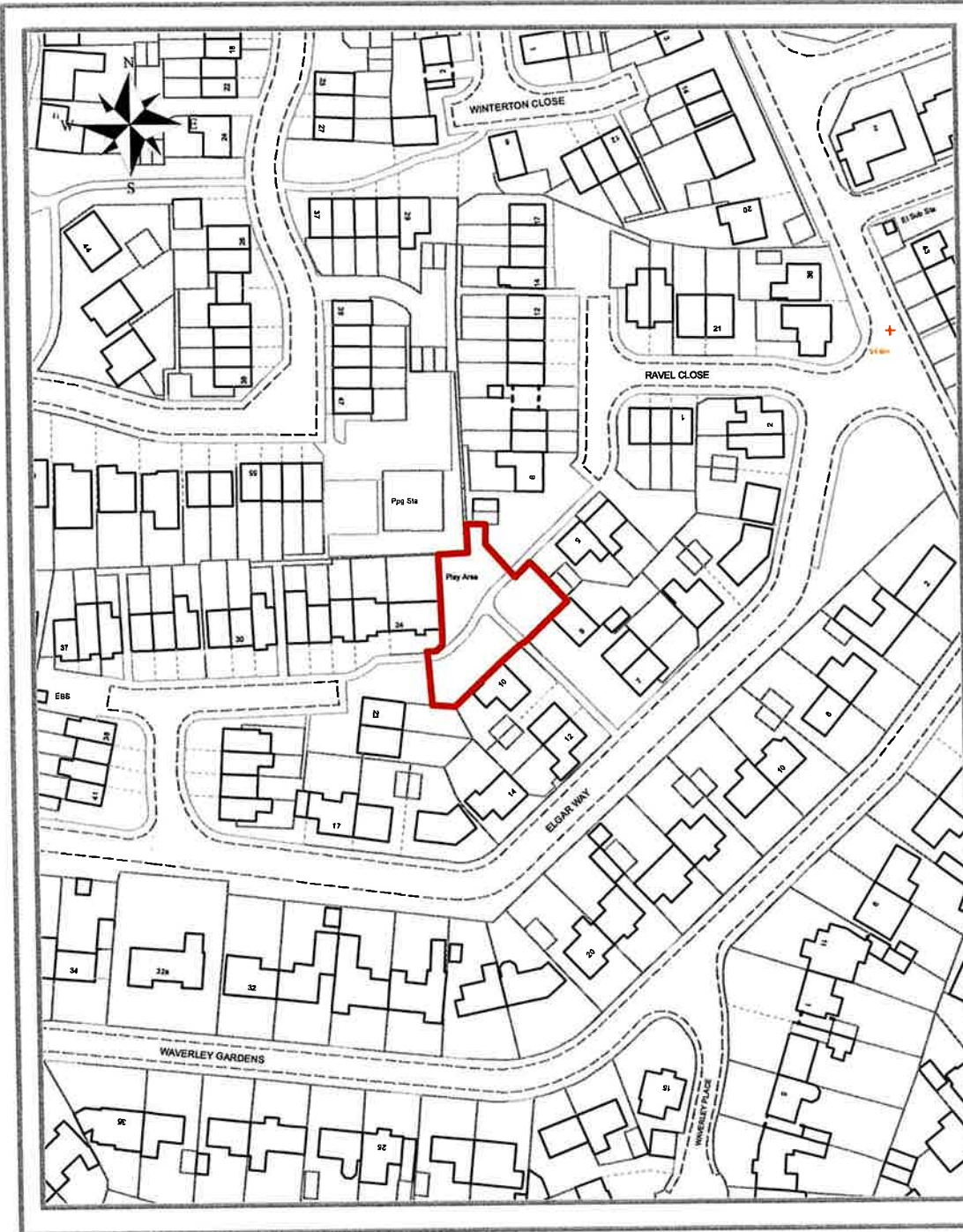

Enclosed play area

Elgar Way,
Stamford

For identification purposes only



SOUTH
KESTEVEN
DISTRICT
COUNCIL



Enclosed play area

Pinewood Close,
Bourne

For identification purposes only



SOUTH
KESTEVEN
DISTRICT
COUNCIL

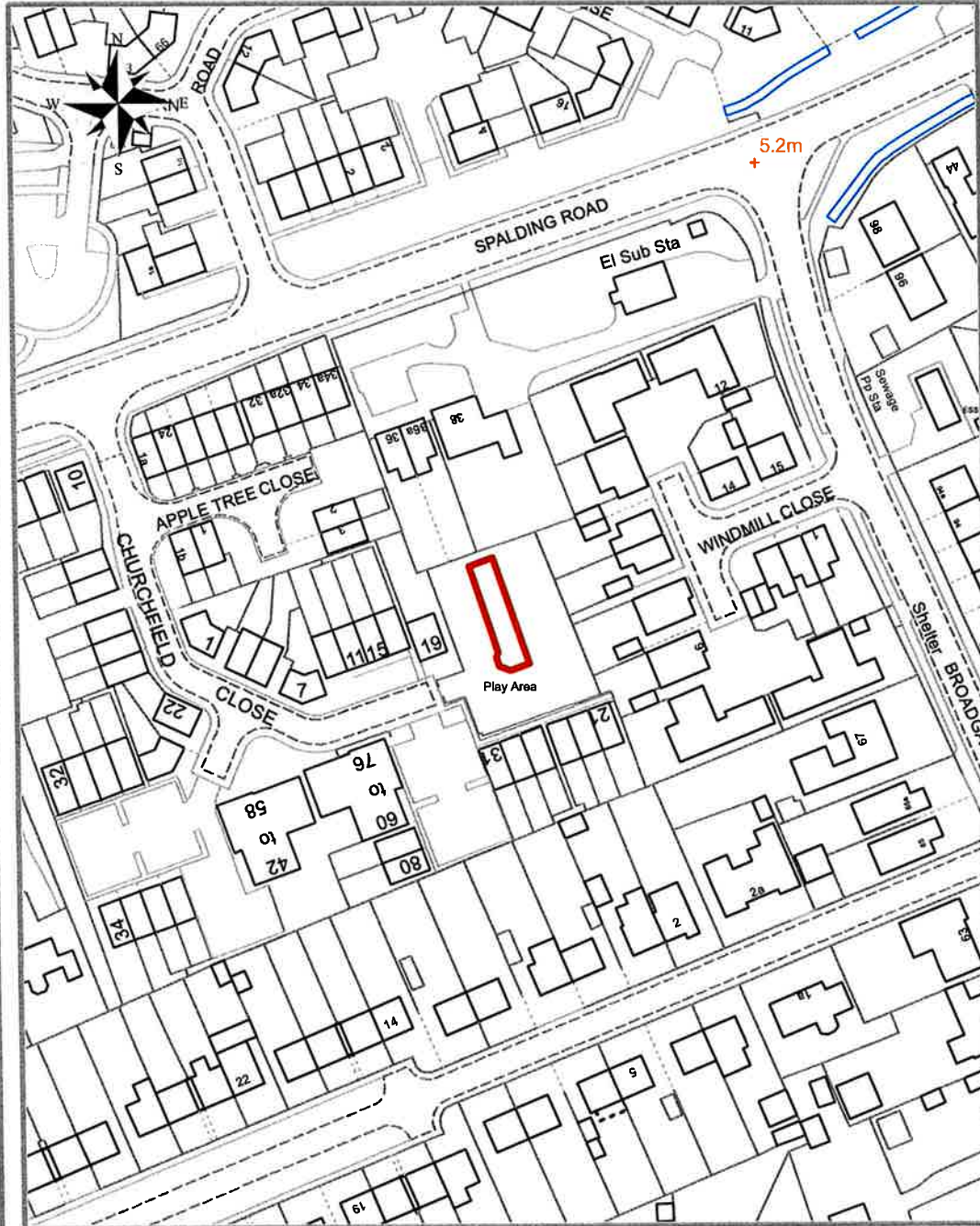

Enclosed play area

Churchfield Close,
Deeping St James

For identification purposes only



SOUTH
KESTEVEN
DISTRICT
COUNCIL

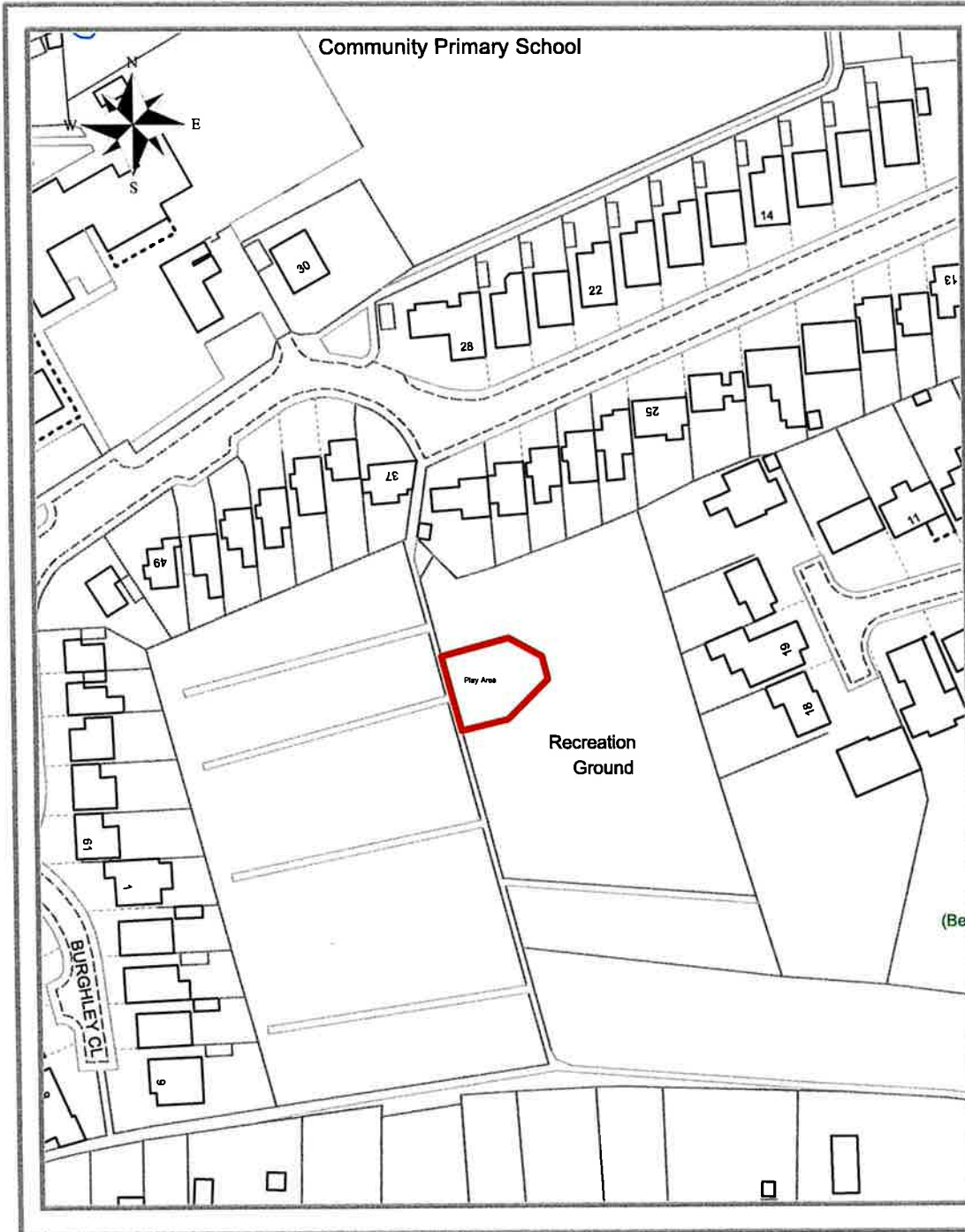

Enclosed play area

**Hereward Way,
Deeping St James**

For identification purposes only



**SOUTH
KESTEVEN
DISTRICT
COUNCIL**

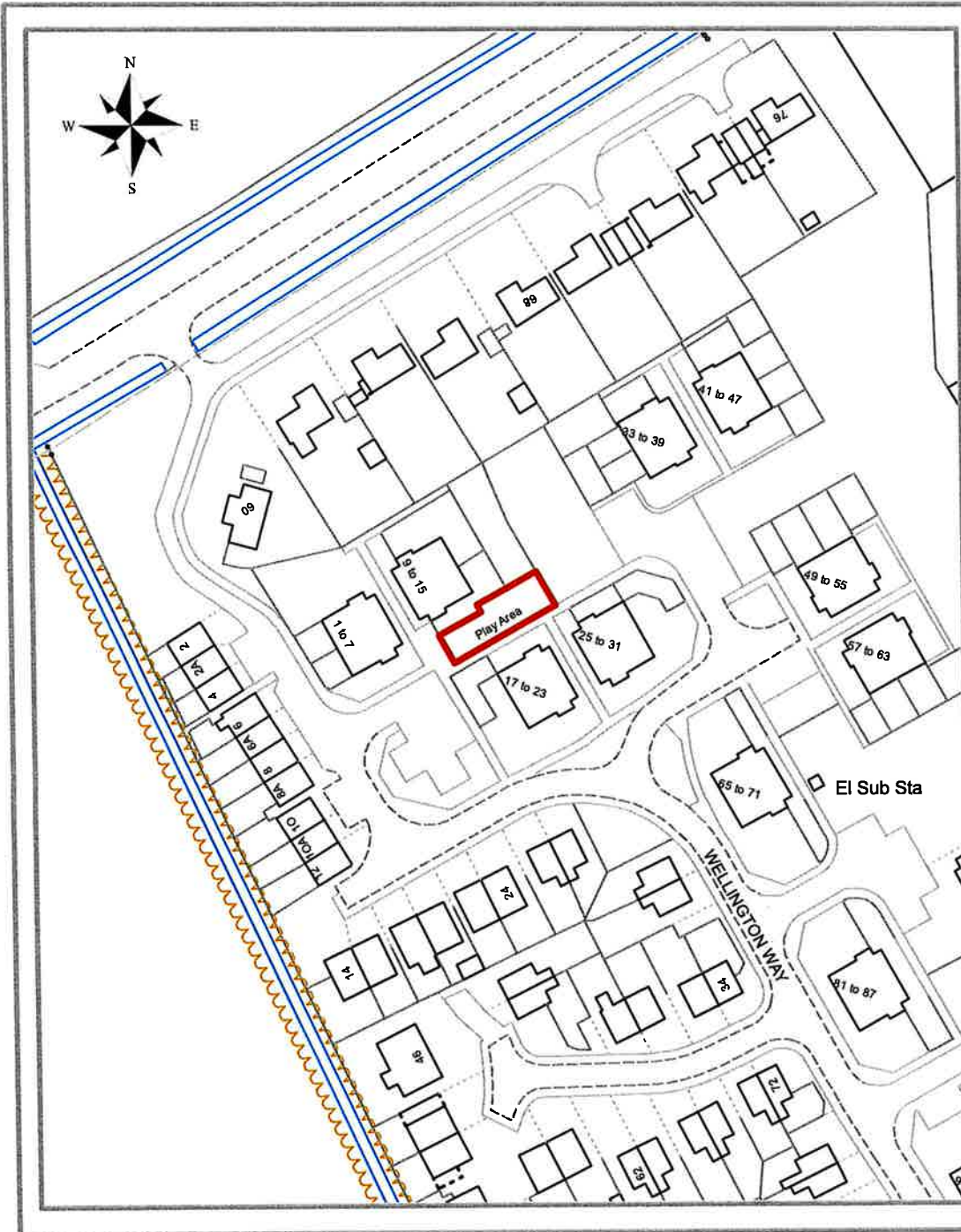

Enclosed play area

Wellington Way,
Market Deeping

For identification purposes only



SOUTH
KESTEVEN
DISTRICT
COUNCIL

The Anti-social Behaviour, Crime and Policing Act 2014

Section 59

South Kesteven District Council (Leads by Order) Public Spaces Protection Order 2023

South Kesteven District Council (in this Order called “the Council”) in exercise of its powers under Section 59 of the Anti-social Behaviour, Crime and Policing Act 2014 (“the Act “) hereby makes the following Order:

The Order is made on the _____ and shall have effect for a period of 3 years thereafter, unless extended by further orders under the Council’s statutory powers.

General provisions:

1. This Order applies to land in the Restricted Areas specified in the Schedule to this Order.
2. The Council is satisfied that both of the conditions set out in Section 59 of the Act are satisfied, because the activity, identified in paragraph 5 of this Order, which is carried on in a public place (“the Restricted Area”) has a detrimental effect on the quality of life of those in the locality and this effect is or is likely to be of a persistent or continuing nature, such as to make the activity unreasonable and justifies the restrictions imposed by this Order.
3. The Order is available for inspection on the Council’s website and also by appointment, at the offices of South Kesteven District Council. Appointments can be made by contacting 01476 406080 or emailing neighbourhoods@southkesteven.gov.uk
4. If any interested person desires to question the validity of this Order on the grounds that the Council had no power to make it or that any requirement of the Act has not been complied with in relation to this Order, he or she may apply to the High Court within six weeks from the date on which this Order is made.

Prohibitions on persons with dogs under their control:

5. Dogs on Leads by Order

A person in charge of a dog on land specified in the Schedule to this Order must comply with a direction given to him by an authorised officer to put and keep the dog on a lead of not more than 1 metre in length unless -

- (a) he has reasonable excuse for failing to do so; or
- (b) the owner, occupier or other person or authority having control of the land has consented (generally or specifically) to his failing to do so.

An authorised officer may only give a direction under this Order to put and keep a dog on a lead of not more than 1 metre if such restraint is reasonably necessary to prevent a nuisance or behaviour by the dog that is likely to cause annoyance or disturbance to any other person on any land to which this Order applies or the worrying or disturbance of any animal or bird.

Exemptions

Nothing in this Order shall apply to a disabled person (within the meaning of the Equality Act 2010) whose disability restricts his ability to comply with the Order and the dog is their guide dog or assistance dog.

For the purpose of this Order:

- (a) Restricted Area means the land designated in the Schedule to this Order.
- (b) A person who habitually has a dog in his possession shall be taken to be in charge of the dog at any time unless at that time some other person is in charge of the dog.
- (c) "an authorised officer" means an officer who is authorised in writing by the Council for the purposes of giving directions under the Order.
- (d) An assistance dog, in general, is one that is trained to aid or assist a disabled person.

Penalty

A person who fails to comply with any obligation imposed by this Order is guilty of an offence and liable to a fine on summary conviction not exceeding level 3 on the standard scale.

An authorised officer may issue a fixed penalty notice (currently £100) to a person who they reasonably believe has breached the requirements of this Order. A fixed penalty notice offers the recipient the opportunity to discharge the liability to conviction for the offence by paying the fixed penalty notice within 14 days of issue of the notice.

Date Order Made:

Executed as a DEED by affixing the)
COMMON SEAL of SOUTH KESTEVEN)
DISTRICT COUNCIL)

In the presence of:

Schedule

This Order applies to all land which is within the administrative area of South Kesteven District Council, edged black on the attached plan, which is open to the air, (which includes land which is covered but open to the air on at least one side) and to which the public are entitled or permitted to have access (with or without payment).

South Kesteven

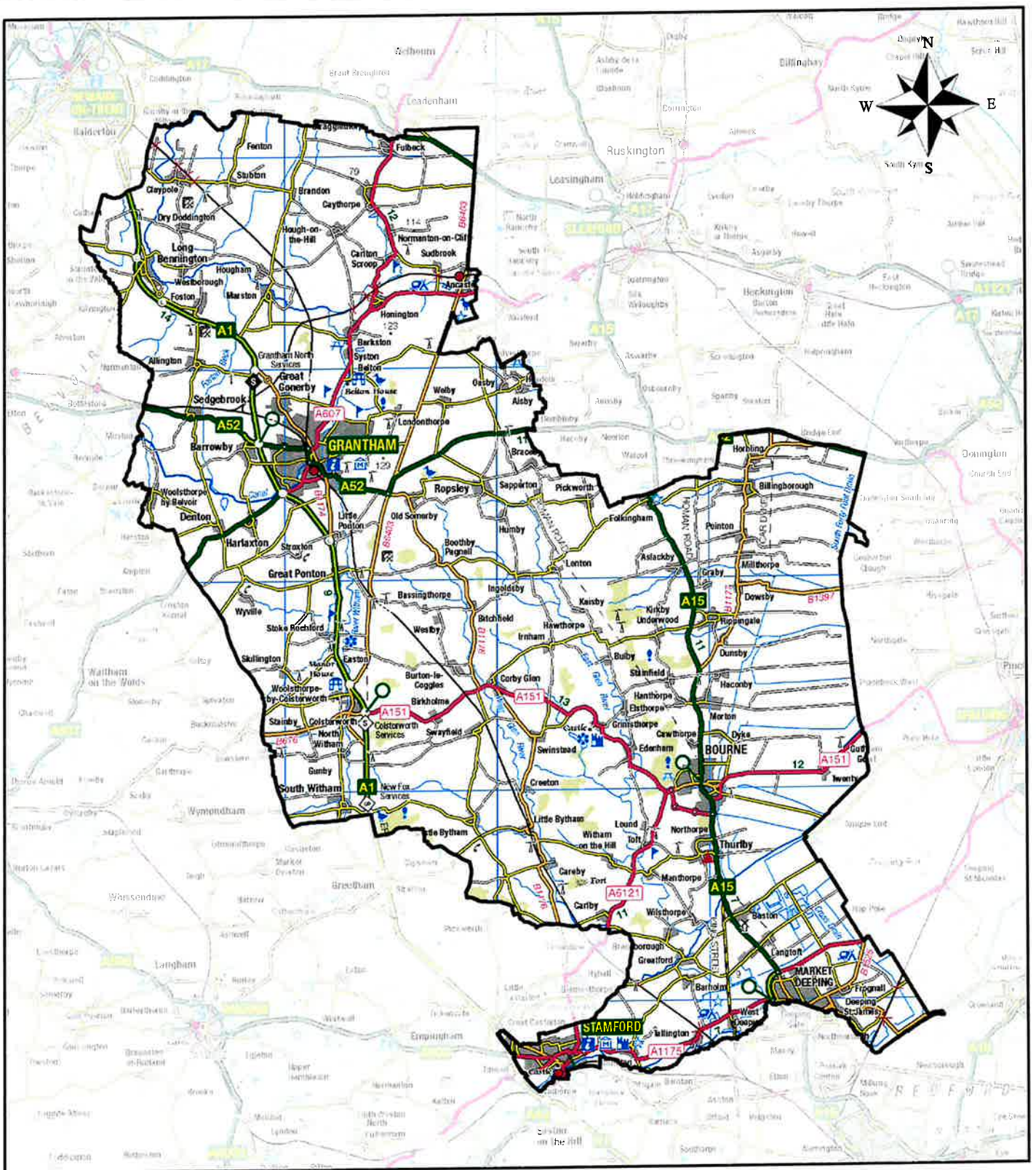

**SOUTH
KESTEVEN
DISTRICT
COUNCIL**

© Crown copyright and database
rights 2020 Ordnance Survey
100018662

The Anti-social Behaviour, Crime and Policing Act 2014 Section

59

South Kesteven District Council (Dogs on Leads) (The Spinney, Market Deeping Cemetery) Public Spaces Protection Order 2023

South Kesteven District Council (in this Order called "the Council") in exercise of its powers under Section 59 of the Anti-social Behaviour, Crime and Policing Act 2014 ("the Act ") hereby makes the following Order:

The Order is made on the _____ and shall have effect for a period of 3 years thereafter, unless extended by further orders under the Council's statutory powers.

General provisions:

1. This Order applies to the land in the Restricted Area specified in the Schedule to this Order.
2. The Council is satisfied that both of the conditions set out in Section 59 of the Act are satisfied, because the activity, identified in paragraph 5 of this Order, which is carried on in a public place ("the Restricted Area") has a detrimental effect on the quality of life of those in the locality and this effect is or is likely to be of a persistent or continuing nature, such as to make the activity unreasonable and justifies the restrictions imposed by this Order.
3. The Order is available for inspection on the Council's website and also by appointment at the offices of South Kesteven District Council. Appointments can be made by contacting 01476 406080 or emailing neighbourhoods@southkesteven.gov.uk
4. If any interested person desires to question the validity of this Order on the grounds that the Council had no power to make it or that any requirement of the Act has not been complied with in relation to this Order, he or she may apply to the High Court within six weeks from the date on which this Order is made.

Obligations on persons with dogs:

5. Dogs on leads

A person in charge of a dog on land specified in the Schedule to this Order must keep the dog on a lead of not more than 1 metre in length unless (a) he has reasonable excuse for failing to do so; or

(b) the owner, occupier or other person or authority having control of the land has consented (generally or specifically) to his failing to do so.

Exemptions

Nothing in this Order shall apply to a disabled person (within the meaning of the Equality Act 2010) whose disability restricts his ability to comply with the Order and the dog is their guide dog or assistance dog.

For the purpose of this Order:

- (a) Restricted Area means the land designated in the Schedule to this Order.
- (b) A person who habitually has a dog in his possession shall be taken to be in charge of the dog at any time unless at that time some other person is in charge of the dog.
- (c) An assistance dog, in general, is one that is trained to aid or assist a disabled person.
- (d) An "authorised officer" means an officer who is authorised in writing by the Council for the purposes of giving directions under the Order.

Penalty

A person who fails to comply with any obligation imposed by this Order is guilty of an offence and liable to a fine on summary conviction not exceeding level 3 on the standard scale.

An authorised officer may issue a fixed penalty notice (currently E1 00) to a person who they reasonably believe has breached the requirements of this Order. A fixed penalty notice offers the recipient the opportunity to discharge the liability to conviction for the offence by paying the fixed penalty notice within 14 days of issue of the notice.

Date Order Made:

Executed as a DEED by affixing the)
COMMON SEAL of SOUTH KESTEVEN)
DISTRICT COUNCIL)

In the presence of:

Schedule

This Order applies to land which is within the administrative area of South Kesteven District Council, edged black in the attached plans, which is open to the air (which includes land which is covered, but open to the open air on at least one side) and to which the public are entitled or permitted to have access (with or without payment).

The Spinney, Market Deeping Cemetery

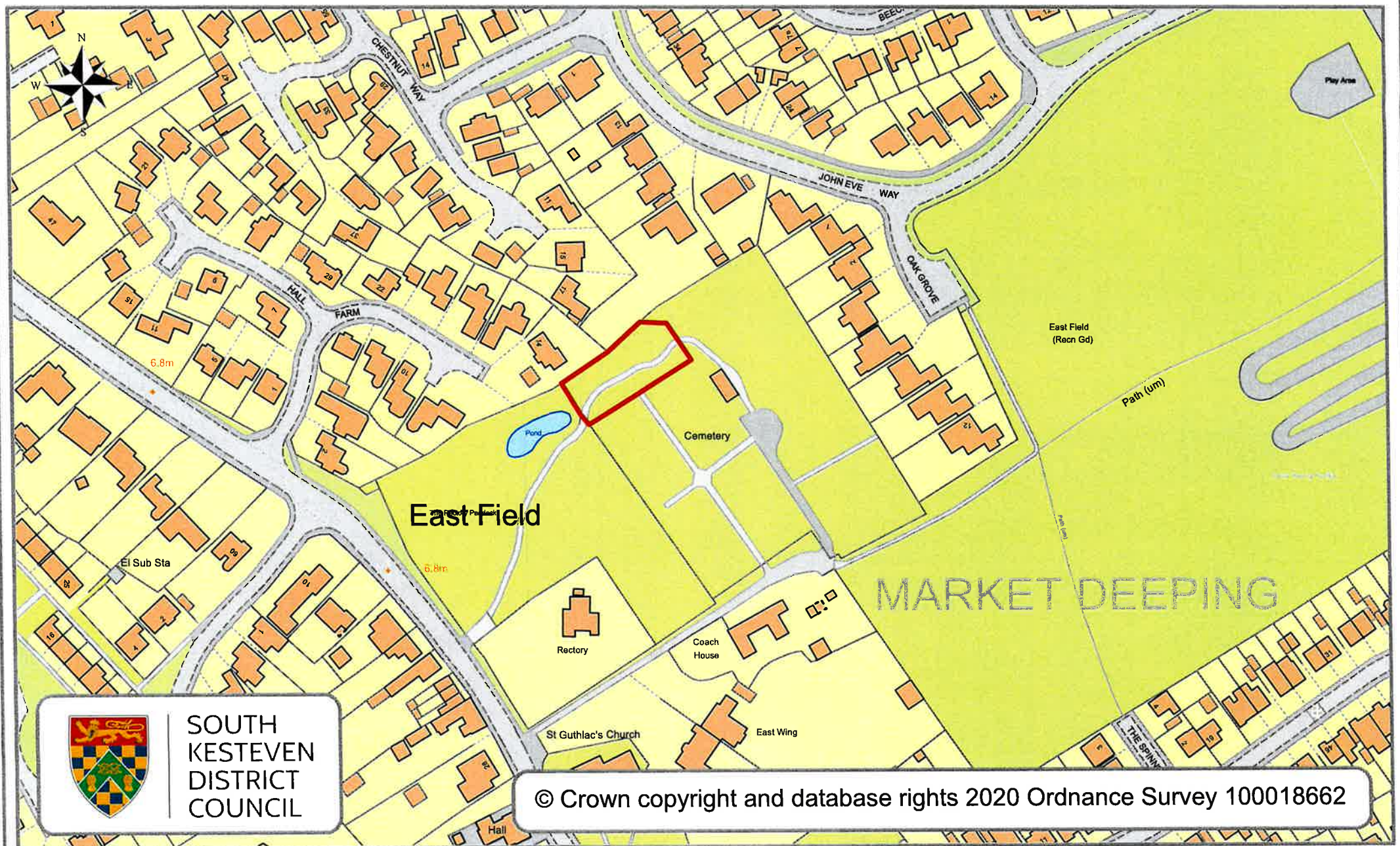

© Crown copyright and database rights 2020 Ordnance Survey 100018662

The Anti-social Behaviour, Crime and Policing Act 2014

Section 59

South Kesteven District Council (Dog Fouling) Public Spaces Protection Order 2023

South Kesteven District Council (in this Order called “the Council”) in exercise of its powers under Section 59 of the Anti-social Behaviour, Crime and Policing Act 2014 (“the Act “) hereby makes the following Order:

The Order is made on the _____ and shall have effect for a period of 3 years thereafter, unless extended by further orders under the Council’s statutory powers.

General provisions:

1. This Order applies to land in the Restricted Areas specified in the Schedule to this Order.
2. The Council is satisfied that both of the conditions set out in Section 59 of the Act are satisfied, because the activity, identified in paragraph 5 of this Order, which is carried on in a public place (“the Restricted Area”) has a detrimental effect on the quality of life of those in the locality and this effect is or is likely to be of a persistent or continuing nature, such as to make the activity unreasonable and justifies the restrictions imposed by this Order.
3. The Order is available for inspection on the Council’s website and also by appointment, at the offices of South Kesteven District Council. Appointments can be made by contacting 01476 406080 or emailing neighbourhoods@southkesteven.gov.uk
4. If any interested person desires to question the validity of this Order on the grounds that the Council had no power to make it or that any requirement of the Act has not been complied with in relation to this Order, he or she may apply to the High Court within six weeks from the date on which this Order is made.

Prohibitions on persons with dogs under their control:

5. Dog Fouling

If a dog defecates at any time on land specified in the Schedule to this Order a person who is in charge of the dog at the time must remove the faeces from the land forthwith unless -

- (a) he has reasonable excuse for failing to do so; or
- (b) the owner, occupier or other person or authority having control of the land has consented (generally or specifically) to his failing to do so.

Exemptions

Nothing in this Order shall apply to a disabled person (within the meaning of the Equality Act 2010) whose disability restricts his ability to comply with the Order and the dog is their guide dog or assistance dog.

For the purpose of this Order:

- (a) Restricted Area means the land designated in the Schedule to this Order.
- (b) A person who habitually has a dog in his possession shall be taken to be in charge of the dog at any time unless at that time some other person is in charge of the dog.
- (c) Being unaware of the defecation (whether by reason of not being in the vicinity or otherwise) shall not be a reasonable excuse for failing to remove the faeces.
- (d) An assistance dog, in general, is one that is trained to aid or assist a disabled person.
- (e) An "authorised officer" means an officer who is authorised in writing by the Council for the purposes of giving directions under the Order.

Penalty

A person who fails to comply with any obligation imposed by this Order is guilty of an offence and liable to a fine on summary conviction not exceeding level 3 on the standard scale.

An authorised officer may issue a fixed penalty notice (currently £100) to a person who they reasonably believe has breached the requirements of this Order. A fixed penalty notice offers the recipient the opportunity to discharge the liability to conviction for the offence by paying the fixed penalty notice within 14 days of issue of the notice.

Date Order Made:

Executed as a DEED by affixing the)
COMMON SEAL of SOUTH KESTEVEN)
DISTRICT COUNCIL)

In the presence of:

Schedule

This Order applies to all land which is within the administrative area of South Kesteven District Council, edged black on the attached plan, which is open to the air (which includes land which is covered, but open to the open air on at least one side) and to which the public are entitled or permitted to have access (with or without payment).

South Kesteven

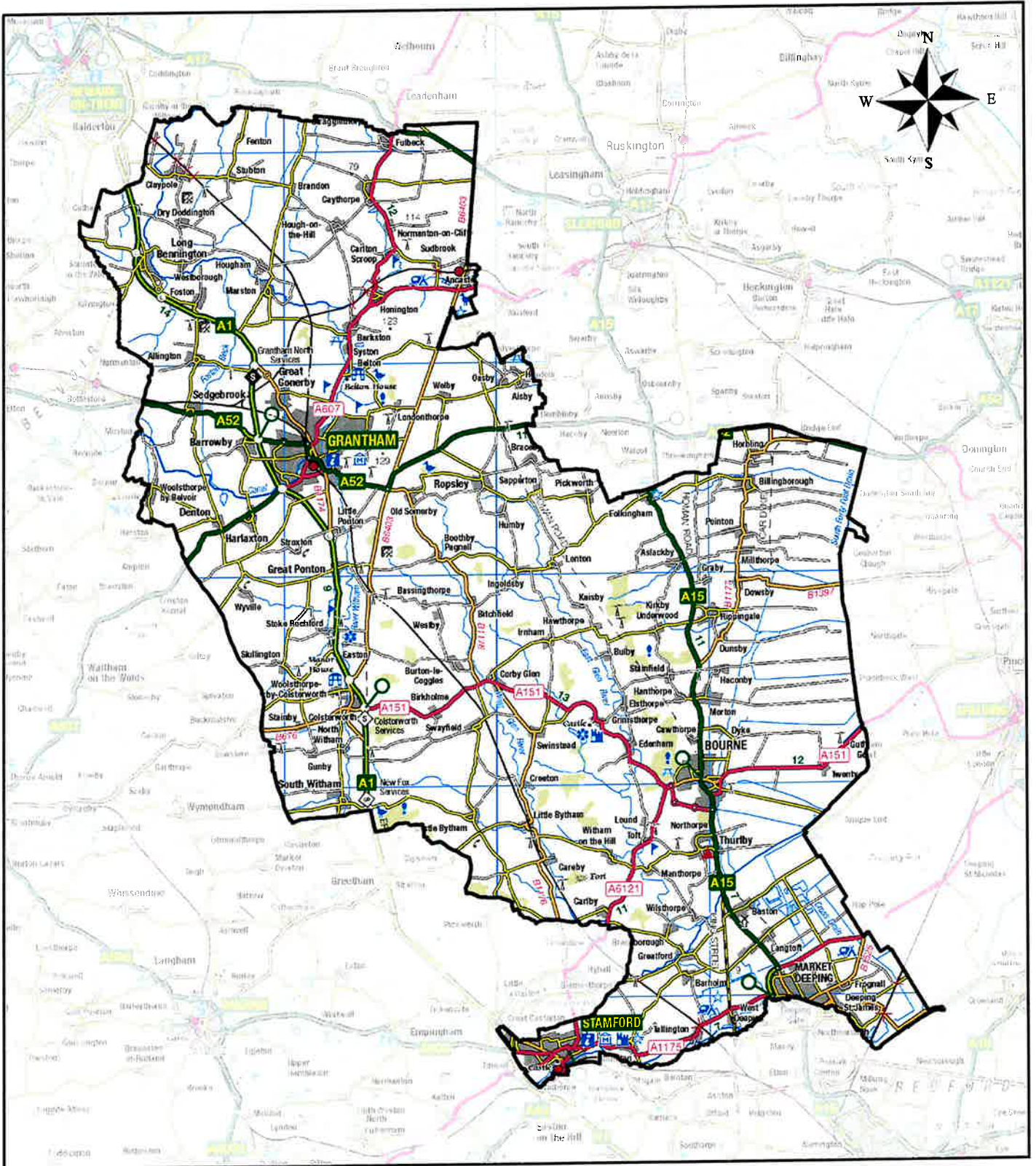

**SOUTH
KESTEVEN
DISTRICT
COUNCIL**

© Crown copyright and database
rights 2020 Ordnance Survey
100018662